

Ref: 8239



SEAMOUNT COTTAGE, COURTTOWN, GOREY, CO. WEXFORD Y25 PE03

BER E1

QUINN PROPERTY

www.quinnproperty.ie

Charming Old Fisherman's Cottage With Annex / Workshop Space For Sale By Private Treaty



LOCATION:

This property enjoys a fantastic prime location in Courtown Village, which is a bustling seaside resort with beautiful views, a lively atmosphere, and a vast array of amenities including pubs, restaurants, activity & leisure center, amusement arcades. The Active Tribe Courtown Leisure and Adventure Centre in Courtown consists of a swimming pool, recreation center, gym and physical fitness center. Wexford County Council has recently granted planning permission for a new 136-bedroom hotel in the area, set to significantly boost local tourism and enhance the region's appeal to visitors.

With access to the M11 within a 6 minute drive from Courtown, this property offers a comfortable commute to Wexford Town within 45 minutes and South Dublin within 70 minutes.

DESCRIPTION:

This charming old fisherman's cottage tucked just a stone's throw from Courtown Harbour is the idyllic hideaway which offers a taste of traditional coastal life. With its stone walls, slate roof, and a cosy interior, it feels steeped with character and offers the perfect spot for a peaceful escape. This property also has a separate annex / workshop space with independent access.

Accommodation comprises of:



Porch:	1.23m x 1.4m	Tiled flooring
Living Room:	4.25m x 3.17m	Timber flooring, brick fire place with stove
Kitchen:	2.55m x 2.09m	Tiled flooring in kitchen, electric cooker with gas hob, plumed for a washing machine
Dinning Room:	3.99m x 3.18m	Tiled flooring, fitted units
Shower Room:	2.83m x 1.54m	Fully tiled, W.C., W.H.B., fitted units, electric shower.
Bedroom 3:	3.49m x 1.99m	Laminate flooring, fitted shelves.
Hallway:	3.13m x 3.02m	Tiled flooring, door to side yard
Landing:	2.70m x 1.99m	
Master bedroom:	3.46m x 3.17m	Laminate flooring, fitted wardrobes
Bedroom 2:	3.62m x 1.99m	Laminate flooring
Annex / Workshop:	4.94m x 3.35m	Laminate flooring, fitted units, loft storage space.
Shower Room (In Annex / Workshop):	2.64m x 1.29	Tiled, W.C., W.H.B., electric shower





OUTSIDE:

Outside the house is a paved garden to the front with a traditional stone built wall. To the rear there is a private, enclosed yard completed with patio area.

This property also includes a separate annex / workshop with shower room, which is currently being used for storage. This workshop is detached from the residence and has independent access.

This home also features a garden area located directly opposite the home, across the road — an ideal spot for additional outdoor storage or versatile use.



SERVICES AND FEATURES:

All main services
Oil fired central heating
Five minute walk to Courtown harbour
Built in 1900
Property extends 103 sq. metres



BER DETAILS:

BER: E1
BER No. 106203698
Energy Performance Indicator: 308.62kWh/m²/yr



Own A Charming Old Fisherman's Cottage With Annex / Workshop

A.M.V. €250,000

Ground Floor



First Floor

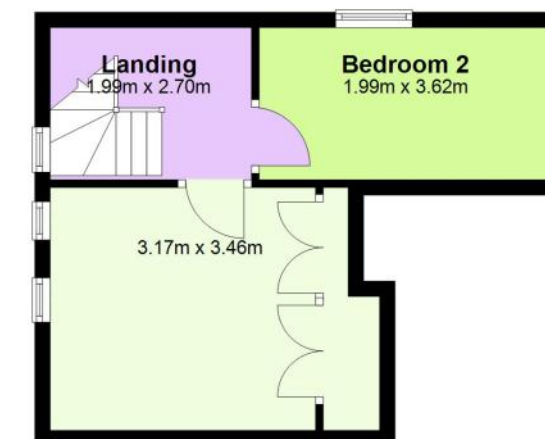

Total area: approx. 103.0 sq. metres

The above particulars are issued by QUINN PROPERTY on the understanding that any negotiations whatsoever concerning the property are conducted through QUINN PROPERTY. Every care has been taken in the preparation of these particulars, but the Auctioneer does not hold himself responsible for any inaccuracy, or for any expense incurred in inspecting the property should it not be suitable, or withdrawn from sale.