

RICE+ROMAN



Holly Place, Cobham

KT11 3EB



Living Area

Holly Place, High Street, Cobham, Surrey, KT11 3EB

Approximate Floor Area = 81.6 sq m / 878 sq ft

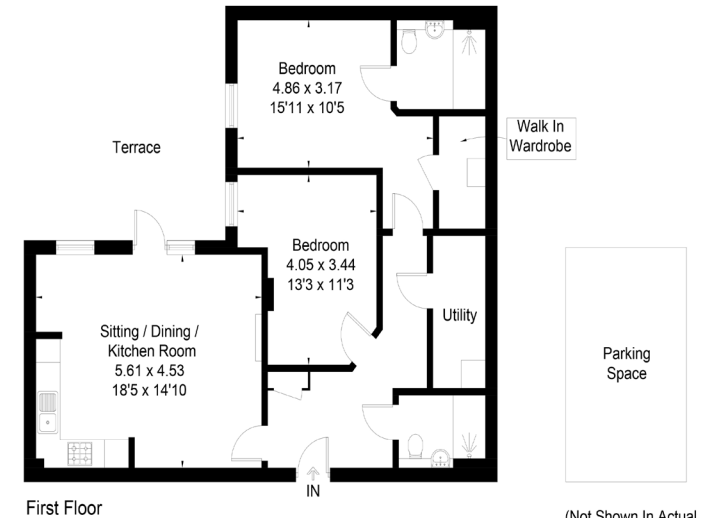

First Floor

(Not Shown In Actual
Location / Orientation)



This floor plan has been drawn in accordance with RICS Property Measurement 2nd edition.
All measurements, including the floor area, are approximate and for illustrative purposes only. @fourwalls-group.com #76499

- Exclusively For Those Aged 60+
- South Facing Aspect
- On-Site Management
- Allocated Parking Space
- Lift Accessible
- High Street Location

Price: £629,950

Service Charge: £5,400 PA

Ground Rent: £595 PA

Other Charges: N/A

Lease Length: 994 years left

Tenure: Leasehold

EPC Rating: B

For more information
please contact:

Rice & Roman
T: 01344 981246
E: info@riceandroman.co.uk
Lynwood Village, SL50FJ
www.riceandroman.co.uk

RICE + ROMAN

Agents Notices - These property details are set out as a general outline only and do not constitute any part of an Offer or Contract. Any services, equipment, fittings or central heating systems have not been tested and no warranty is given or implied that these are in working order. Buyers are advised to obtain verification from their solicitor or surveyor. Fixtures, fittings and other items are not included unless specifically described. All measurements, distances and areas are approximate and for guidance only. Room measurements are taken to be the nearest 10cm and prospective buyers are advised to check these for any particular purpose, e.g. fitted carpets and furniture. This material is protected by the laws of copyright. The owner of the copyright is Countrywide Estate Agents. This property sheet forms part of our database rights and copyright laws. No unauthorised copying or distribution without permission.