

RICE+ROMAN



Wellington Lodge, Camberley

GU15 3QD





## Living Room

Wellington Lodge, Camberley, GU15 3QD

Approximate Floor Area = 67.5 sq m / 726 sq ft

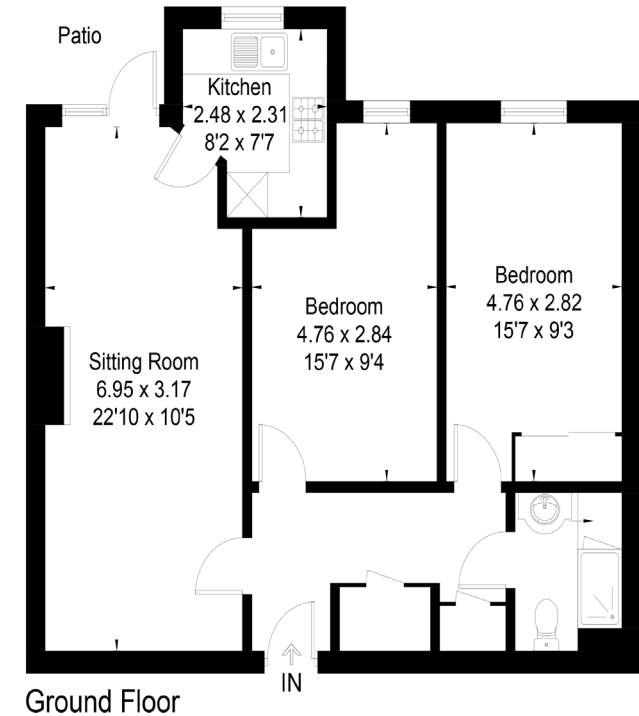

- Ground floor
- Two double bedrooms
- Kitchen with a window
- Shower room
- Development Owners' Lounge
- On-site Manager

Price: £250,000  
 Service Charge: £4,221.85 PA  
 Ground Rent(G/R): £659.38 PA  
 Lease Length: 107 Years  
 G/R Review: 2028

EPC Rating: TBC

For more information  
 please contact:

Rice & Roman  
 T: 01344 981246  
 E: [info@riceandroman.co.uk](mailto:info@riceandroman.co.uk)  
 Lynwood Village, SL50FJ  
[www.riceandroman.co.uk](http://www.riceandroman.co.uk)

RICE +  
 ROMAN

Agents Notices - These property details are set out as a general outline only and do not constitute any part of an Offer or Contract. Any services, equipment, fittings or central heating systems have not been tested and no warranty is given or implied that these are in working order. Buyers are advised to obtain verification from their solicitor or surveyor. Fixtures, fittings and other items are not included unless specifically described. All measurements, distances and areas are approximate and for guidance only. Room measurements are taken to be the nearest 10cm and prospective buyers are advised to check these for any particular purpose, e.g. fitted carpets and furniture. This material is protected by the laws of copyright. The owner of the copyright is Countrywide Estate Agents. This property sheet forms part of our database rights and copyright laws. No unauthorised copying or distribution without permission.