



5 SOUTH VIEW TERRACE, BIDEFORD, EX39 3LR

£235,000

A spacious 5 bedroom terraced home set over three floors, featuring uPVC double glazing & gas central heating. Ideally located within walking distance of the town centre, Victoria Park & local schools this is an excellent family home offering comfort, convenience and generous living space.

No5 will be found offering an impressive 1700sqft of accommodation over three floors, including 2 comfortable receptions rooms and 5 well proportioned bedrooms.

South View Terrace is located towards the lower reaches of Northdown Road, conveniently positioned for walking access to Bideford town centre, Victoria Park & local primary & secondary schooling whilst avid walkers & dog owners can also utilise the nearby Kenwith Valley Nature Reserve.

The property has the benefit of gas fired central heating & uPVC double glazing whilst still retaining Many original features including ornate fireplaces, original doors & ceiling cornice.

The main living spaces features a bay fronted lounge & separate dining room, which are linked via imposing wooden bi-fold doors whilst a functional fitted kitchen comprising a good selection of cupboards & drawers, is complimented by a useful pantry/utility area.

Externally there are low maintenance courtyard gardens to both the front & rear – the front being south facing whilst there are parking options on Northdown Road, on a first come, first served basis.

Services: All mains services are connected
Energy Performance Certificate: E (45)
Council Tax: BAND C (£2,244.47 per annum)



Ground Floor

Approx. 60.3 sq. metres (649.3 sq. feet)

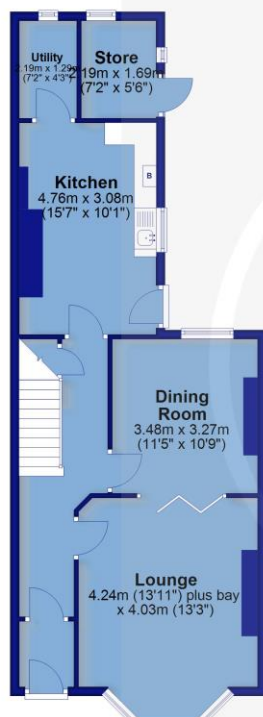

First Floor

Approx. 57.2 sq. metres (615.6 sq. feet)



Second Floor

Approx. 41.9 sq. metres (451.3 sq. feet)



For clarification we wish to inform prospective purchasers that we have prepared these sales particulars as a general guide. We have not carried out a detailed survey, nor tested the services, appliances and specific fittings. Room sizes should not be relied upon for carpets and furnishings. If there are any important matters which are likely to affect your decision to buy, please contact us before viewing the property. No responsibility can be accepted for any expenses incurred by any intending purchaser in inspecting properties which have been sold, let or withdrawn.