



19 LIME GROVE, BIDEFORD, EX39 3JJ

£245,000

A stunning 3 bedroom terraced house situated in convenient town centre location and offering contemporary accommodation including 2 reception rooms, stylish modern kitchen & loft room whilst benefiting from gas central heating, uPVC double glazing & south facing garden with useful workshop.

19 Lime Grove is a beautifully refurbished terraced home that seamlessly blends period charm with stylish modern enhancements. Ideally located just minutes from the town centre, a variety of local amenities, and the greenery of Victoria Park, it offers both convenience and character.

Behind its attractive red brick façade, the home reveals well proportioned interiors enhanced by high ceilings and large windows that flood the space with natural light.

The ground floor flows effortlessly from front to back, with an inviting bay-fronted lounge featuring a charming fireplace, separate dining room and culminating in a superbly remodelled kitchen complete with a breakfast bar - perfect for casual dining or entertaining.

Upstairs, you'll find three bedrooms, including a spacious main with bespoke fitted wardrobes. A versatile loft room offers an ideal space for hobbies and crafts or serves as an occasional bedroom for guests.

Outside, just beyond the kitchen, a useful laundry/utility area with WC provides added functionality. Steps then lead up to a south-facing garden - an ideal sun trap during the warmer months. The low-maintenance patio is framed by raised beds and vibrant borders, bringing colour and life to the outdoor space. A generous 13' x 13' shed, with power connected, adds excellent storage or workshop potential.

Services: All mains services are connected

Energy Performance Certificate: D (63)

Council Tax: BAND B (£1,963.91 per annum)



Ground Floor

Approx. 48.5 sq. metres (521.7 sq. feet)

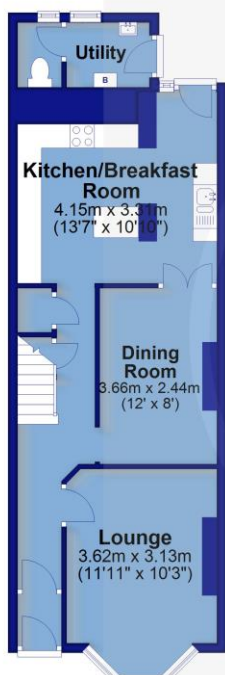

First Floor

Approx. 40.7 sq. metres (438.0 sq. feet)



Second Floor

Approx. 22.3 sq. metres (239.8 sq. feet)

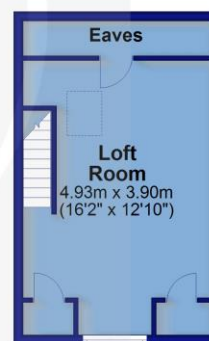

For clarification we wish to inform prospective purchasers that we have prepared these sales particulars as a general guide. We have not carried out a detailed survey, nor tested the services, appliances and specific fittings. Room sizes should not be relied upon for carpets and furnishings. If there are any important matters which are likely to affect your decision to buy, please contact us before viewing the property. No responsibility can be accepted for any expenses incurred by any intending purchaser in inspecting properties which have been sold, let or withdrawn.