

ROKSTONE



Lyons Place, NW8

The stunning one bedroom apartments at Lyons Place all boast private outdoor spaces, whilst maximising the use of space, finest materials and finishes, to create the perfect home and/ or investment. This boutique scheme of apartments, designed by renowned architect Sir Terry Farrell, considered to be one of Central London's best luxury boutique schemes.

Lyons Place is an exceptional new boutique development from luxury developer, Almacantar, nestled between some of London's most exclusive residential neighbourhoods in Zone 1, Lyons Place has a prestigious Westminster NW8 postcode, enjoying the local amenities of Maida Vale for Regent's Canal and Little Venice, whilst being moments from Marylebone and the West End. This new luxury boutique scheme sits in a calm green oasis within one of London's most vibrant neighbourhoods. Framed by tree-lined streets, Lyons Place is positioned at the heart of a lively local community, offering village style living just moments from the city centre with immediate access to a huge range of independent boutiques, restaurants and cafés, as well as some world class academic and healthcare institutions.

In keeping with the rich, local environment, each of the beautifully crafted, boutique 1-2-3 bedroom apartments, Penthouses and Town houses come with significant outside space and an abundance of natural light; all focused around a calming, landscape courtyard. Our website has any additional information you may require.

Price £1,250,000



5 Dorset Street London W1U 6QJ
Tel: 020 7580 2030 | Email: enquiries@rokstone.com
<https://www.rokstone.com>

Lyons Place

Approx. Gross Internal Area 840 Sq Ft - 78.04 Sq M
Approx. External Area Of Balcony 314 Sq Ft - 29.17 Sq M

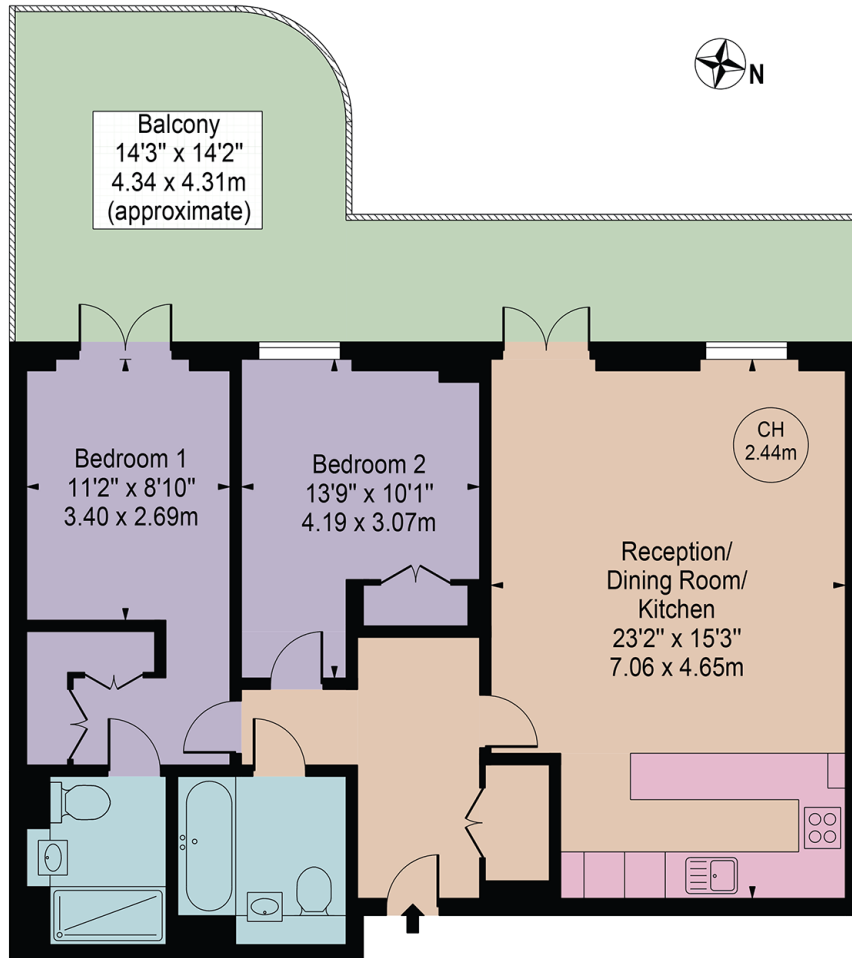

First Floor

For Illustration Purposes Only - Not To Scale

This floor plan should be used as a general outline for guidance only and does not constitute in whole or in part an offer or contract. Any intending purchaser or lessee should satisfy themselves by inspection, searches, enquiries and full survey as to the correctness of each statement. Any areas, measurements or distances quoted are approximate and should not be used to value a property or be the basis of any sale or let.

Terms

Local Authority: Westminster City Council

Tenure: Leasehold

Lease: 995

Service Charge: £4,283.81HY

Ground Rent: £TBC