



TAYLOR GIBBS

Residential Sales, Lettings & Management Agents

Highgate Hill, Highgate, N6
Price £475 pw - To Let

A two bedroom split level apartment occupying the top floor of an Edwardian period conversion situated in the heart of Highgate Village. Flooded in natural light, the accommodation comprises a spacious reception room, separate kitchen with space for dining, large primary bedroom, second bedroom and a bathroom with a separate WC. There is CPZ street parking available and the flat is heated by gas central heating. The property is conveniently located opposite the picturesque surroundings of Waterlow Park, within walking distance of both Highgate and Archway Underground Stations and only moments away from the restaurants, cafes and bars on Highgate High Street.

Please note that £475 per week is the equivalent of £2058.33p per calendar month

Council Tax: Haringey Band E

Tenancy Term: 12 months

Approx. Floor Area: 988 sqft (91.79 sqm)



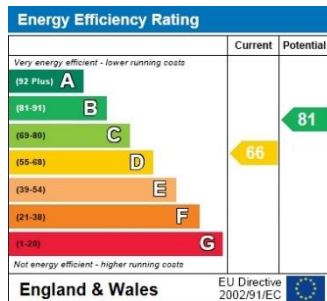
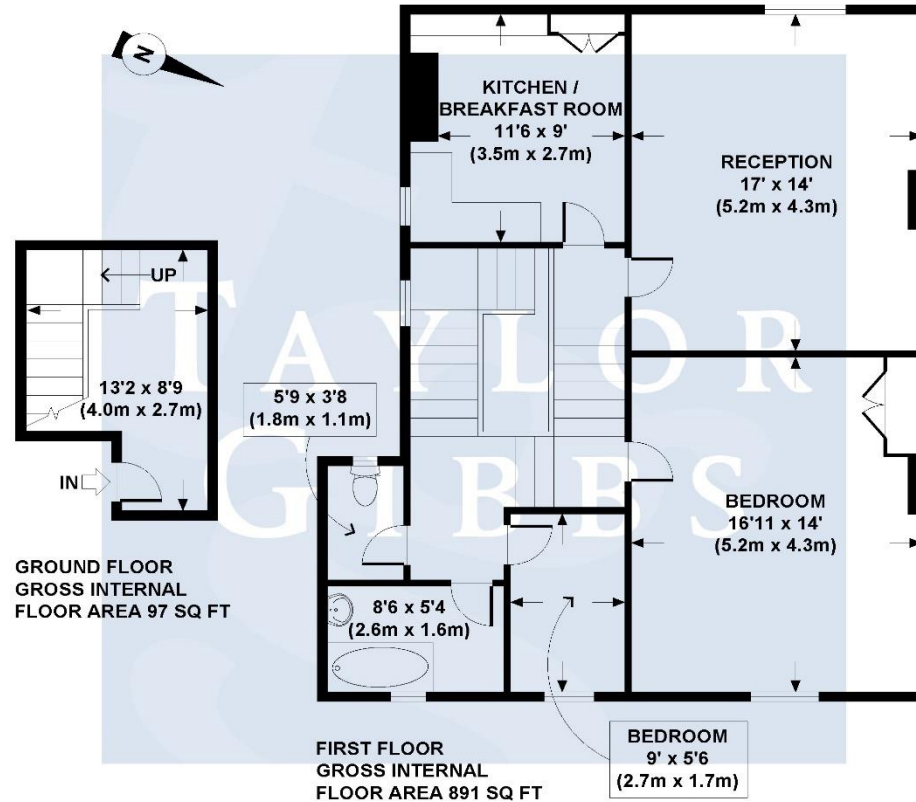

APPROX. GROSS INTERNAL FLOOR AREA 988 SQ FT / 92 SQ M.
HIGHGATE HILL, N6

TAYLORG9274

THIS IMAGE IS ILLUSTRATIVE ONLY - NOT TO SCALE
No accuracy to this image, text or measurements is guaranteed. Copyright © The Image Tailor Ltd. 2010 -
Unauthorised reproduction prohibited - www.themagetailor.com



TAYLOR GIBBS

Residential Sales, Lettings & Management Agents

33 Highgate High Street, Highgate, London, N6 5JT

Tel: 020 8341 0123

enquiries@taylorgibbs.co.uk

www.taylorgibbs.co.uk

