



TAYLOR GIBBS
Residential Sales, Lettings & Management Agents

Milton Road, Highgate, N6
Price £1,950 pcm - To Let

A bright and spacious two bedroom period conversion occupying the first floor of this Edwardian terraced house situated within close walking distance to Highgate Underground Station. The accommodation consists of a large reception room with a beautiful period fireplace, separate kitchen, two double bedrooms, the primary bedroom benefiting from fitted wardrobes, a bathroom and separate cloakroom. Further benefits to the apartment include an array of period features with traditional cornicing, picture rails and large sash windows. The property is located in a controlled parking zone and street parking is available with a permit required between 10am to 12pm, Monday to Friday. The property is ideally situated within close walking distance to the amenities of Highgate Village and Crouch End Broadway.

Please note that £450 per week is the equivalent of £1,950 per calendar month.

Council Tax: Haringey Band D

Tenancy Term - 12 months

Approx. Floor Area: 629 sqft (58 sqm)



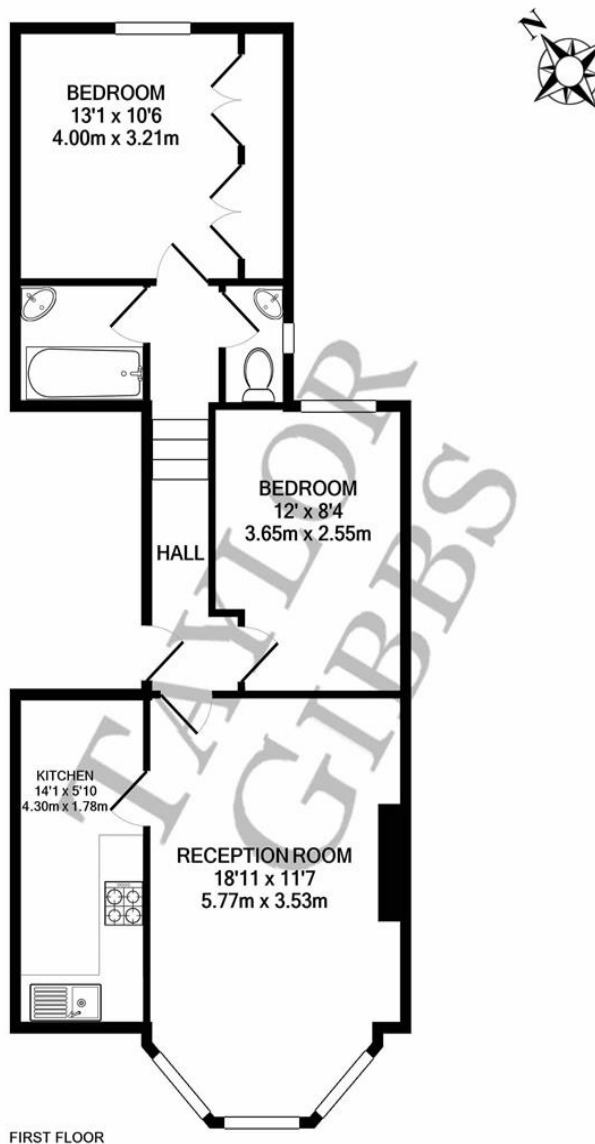

Energy Efficiency Rating		
	Current	Potential
Very energy efficient - lower running costs		
(92-100) A		81
(81-91) B		
(69-80) C		
(55-68) D	67	
(39-54) E		
(21-38) F		
(1-20) G		
Not energy efficient - higher running costs		
England & Wales	EU Directive 2002/91/EC	

MILTON ROAD N6
TOTAL APPROX. FLOOR AREA 629 SQ.FT. (58.4 SQ.M.)
Measurements are approximate. Not to scale. Illustrative purposes only



TAYLOR GIBBS

Residential Sales, Lettings & Management Agents

33 Highgate High Street, Highgate, London, N6 5JT
Tel: 020 8341 0123
enquiries@taylorgibbs.co.uk
www.taylorgibbs.co.uk

