



TAYLOR GIBBS

Residential Sales, Lettings & Management Agents

Mount View Road, Stroud Green, N4
Price £1,700 pcm - To Let

A one bedroom ground floor purpose built apartment situated within close walking distance of Harringay Train Station. Boasting original wooden floors throughout, the accommodation comprises a south facing reception room overlooking the communal garden, separate kitchen, shower room and a large double bedroom. Externally there is a well maintained south facing communal garden. The property has gas central heating, fibre broadband is available and there is street CPZ parking with restrictions between 12pm to 2pm, Monday to Friday. The property is ideally situated within walking distance to the multiple amenities of both Crouch End Broadway and Stroud Green.

Please note that £1,700 per calendar month is the equivalent of £392.31 per week.

Council Tax: Haringey Band C

Tenancy Term: 12 months

Approx. Floor Area: 501 sqft (46.54 sqm)



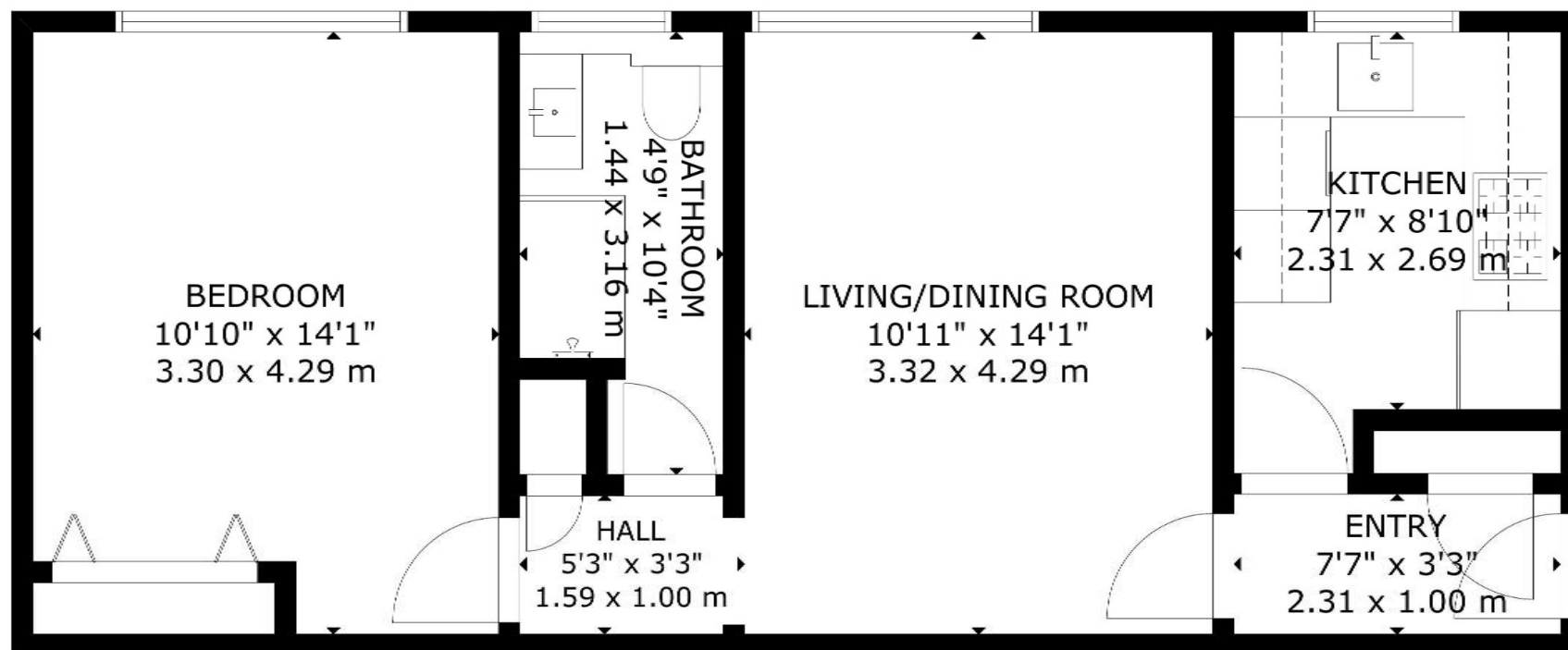
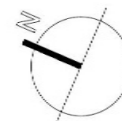

GROUND FLOOR

GROSS INTERNAL AREA
TOTAL: 47 m²/501 sq.ft
GROUND FLOOR: 47 m²/501 sq.ft
SIZE AND DIMENSIONS ARE APPROXIMATE, ACTUAL MAY VARY



TAYLOR GIBBS

Residential Sales, Lettings & Management Agents

33 Highgate High Street, Highgate, London, N6 5JT

Tel: 020 8341 0123

enquiries@taylorgibbs.co.uk

www.taylorgibbs.co.uk

