



TAYLOR GIBBS

Residential Sales, Lettings & Management Agents

Avenue Road, Highgate, N6
Price £500 pw - To Let

An extremely spacious two bedroom apartment located on the top floor of this purpose built block with a private rear garden. The accommodation comprises of a spacious reception room, separate kitchen, two large double bedrooms, utility room and a bathroom with a separate shower cubicle. Externally there is a south facing private garden that backs on to Parkland Walk. The property is serviced by gas central heating with fibre broadband available and CPZ street parking. It's conveniently situated within walking distance of Highgate Underground Station and within a few minutes walk from the multiple amenities of Crouch End Broadway.

Please note that £500 per week is equivalent to £2166.67 per calendar month

Council Tax; Haringey Band E

Tenancy Term: 12 months

Approx. Floor Area: 1012 sqft (94.02 sqm)



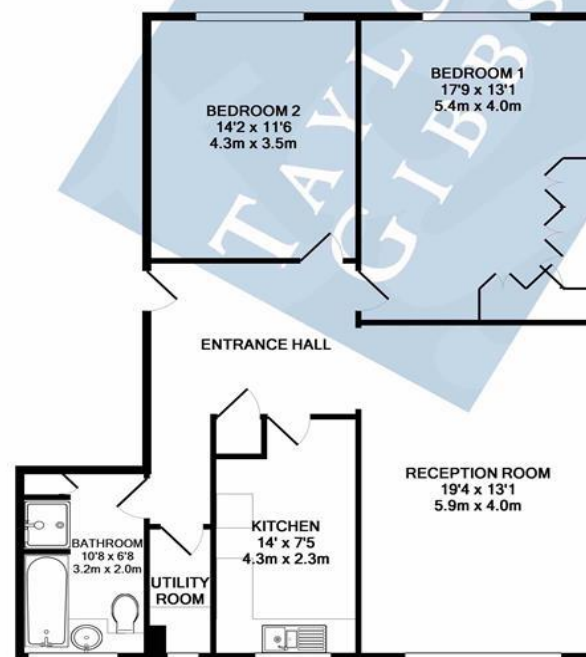

2ND FLOOR

SANDY LODGE N6
TOTAL APPROX. FLOOR AREA 1012 SQ.FT. (94.0 SQ.M.)
Measurements are approximate. Not to scale. Illustrative purposes only

Energy Efficiency Rating		
	Current	Potential
Very energy efficient - lower running costs		
(92-Plus) A		81
(81-91) B		
(69-80) C	68	
(55-68) D		
(39-54) E		
(21-38) F		
(1-20) G		
Not energy efficient - higher running costs		
England & Wales <small>EU Directive 2002/91/EC</small>		



TAYLOR GIBBS

Residential Sales, Lettings & Management Agents

33 Highgate High Street, Highgate, London, N6 5JT

Tel: 020 8341 0123

enquiries@taylorgibbs.co.uk

www.taylorgibbs.co.uk

