



TAYLOR GIBBS

Residential Sales, Lettings & Management Agents

Dartmouth Park Avenue, Dartmouth Park, NW5
Price £475 pw - To Let

A two bedroom apartment occupying the top floor of this double fronted period residence located within walking distance to Tufnell Park Underground Station. Boasting a south-west facing balcony with far reaching views towards Hampstead Heath, the accommodation comprises of a spacious reception room opening on to the balcony, a separate fully fitted kitchen, two double bedrooms, both with fitted wardrobes, and a bathroom. The property is conveniently situated within walking distance to Hampstead Heath and Parliament Hill, and is within easy reach to the restaurants, cafes and bars in both Highgate Village and on Swains Lane.

Please note that £475 per week is the equivalent of £2058.33p per calendar month

Council Tax: Camden Band D

Tenancy Term: 12 months

Approx. Floor Area: 729 sqft (67.73 sqm)



DARTMOUTH PARK AVENUE, NW5

Approx. gross internal area
729 Sq.Ft. / 68 Sq.M.

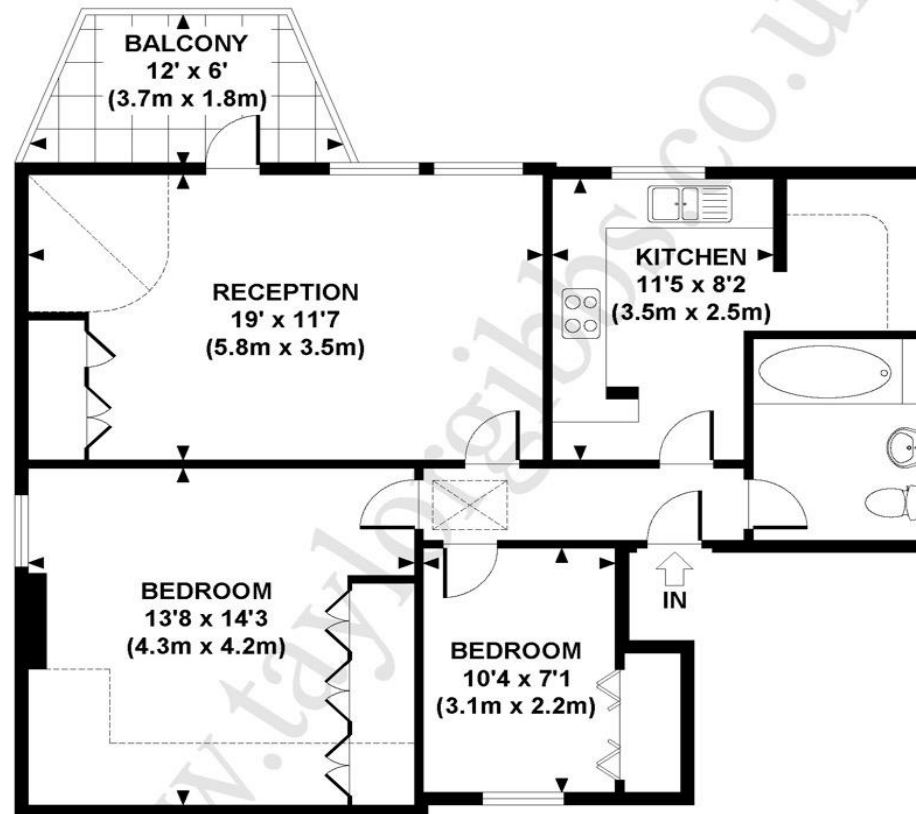

SECOND FLOOR

Energy Efficiency Rating		Current	Potential
Very energy efficient - lower running costs			
(92 Plus)	A		
(81-91)	B		
(69-80)	C		
(55-68)	D		
(39-54)	E	52	54
(21-38)	F		
(1-20)	G		
Not energy efficient - higher running costs			
England & Wales		EU Directive 2002/91/EC	

This Floorplan is for layout guidelines only
*Drawn in accordance with RICS guidelines.
Not drawn to scale unless otherwise stated



TAYLOR GIBBS

Residential Sales, Lettings & Management Agents

33 Highgate High Street, Highgate, London, N6 5JT

Tel: 020 8341 0123

enquiries@taylorgibbs.co.uk

www.taylorgibbs.co.uk

