



TAYLOR GIBBS

Residential Sales, Lettings & Management Agents

Mossborough Close, North Finchley, N12
Price £550 pw - To Let

A three bedroom family home with a garage and off street parking for two cars situated within close walking distance to West Finchley Underground Station and within the catchment for Moss Hall Primary School. The accommodation comprises of a spacious reception room, separate modern fully fitted kitchen, ground floor guest WC, large conservatory, three bedrooms and a family bathroom. The property has a South-East facing garden, garage with an up and over door and access from the rear and is double glazed throughout.

Please note that £550 per week is the equivalent of £2383.33 per calendar month

Council Tax: Barnet Band E

Tenancy Term: 12 months or longer

Approx. Floor Area: 1116 sqft (103.68 sqm)



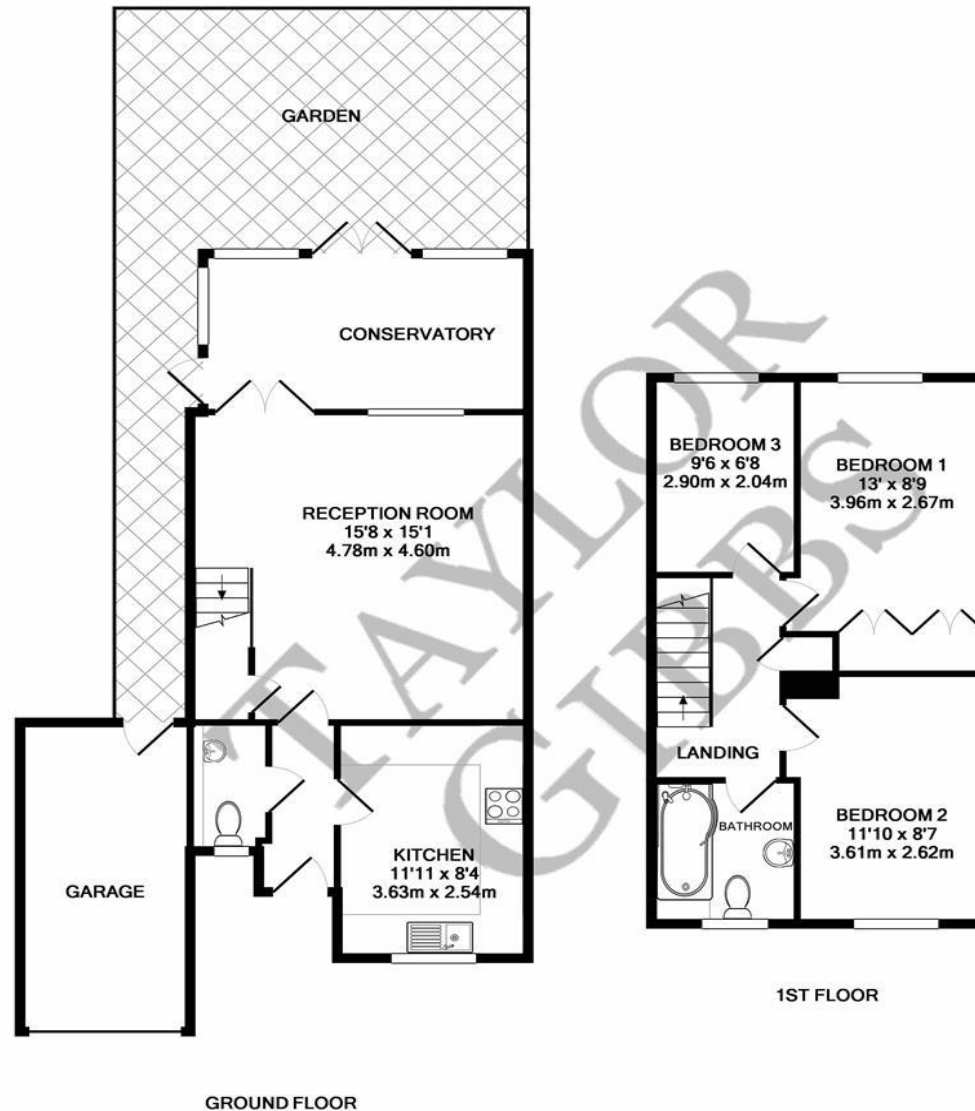

Energy Efficiency Rating		
	Current	Potential
Very energy efficient - lower running costs		
(92-100) A		86
(81-91) B		
(69-80) C	70	
(55-68) D		
(39-54) E		
(21-38) F		
(1-20) G		
Not energy efficient - higher running costs		
England & Wales	EU Directive 2002/91/EC	

MOSSBOROUGH CLOSE N12
 TOTAL APPROX. FLOOR AREA 1116 SQ.FT. (103.7 SQ.M.)
 Measurements are approximate. Not to scale. Illustrative purposes only



TAYLOR GIBBS

Residential Sales, Lettings & Management Agents

33 Highgate High Street, Highgate, London, N6 5JT
 Tel: 020 8341 0123
 enquiries@taylorgibbs.co.uk
 www.taylorgibbs.co.uk

