



TAYLOR GIBBS

Residential Sales, Lettings & Management Agents

Shepherds Hill, Highgate, N6
Price £400 pw - To Let

A one bedroom first floor purpose built apartment situated within close walking distance to Highgate Underground Station. Flooded in natural light and benefiting from wooden floors throughout and double glazed windows, the accommodation comprises a spacious reception room with a picturesque outlook, separate kitchen, double bedroom and a bathroom with a separate WC. The property is serviced by gas central heating with fibre broadband available and CPZ street parking. The property is conveniently located within walking distance to Highgate Village and Crouch End Broadway.

Please note that £400 per week is the equivalent of £1733.33p per calendar month

Council Tax: Haringey Band D

Tenancy Term: 12 months

Approx. Floor Area: 587 sqft (54.53 sqm)



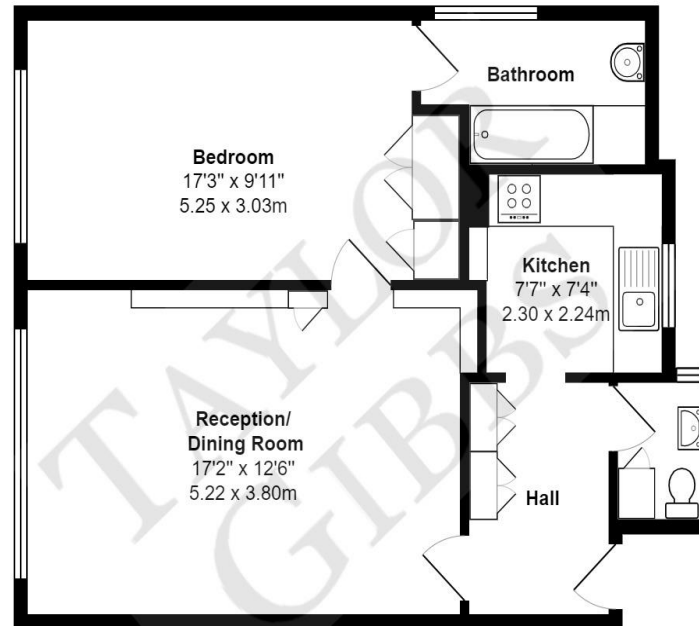

First Floor

Shepherds Hill N6

Total Area: 587 ft² ... 54.6 m²

All measurements are approximate and for display purposes only

Energy Efficiency Rating		
	Current	Potential
Very energy efficient - lower running costs		
(92-100) A		
(81-91) B		
(69-80) C	72	78
(55-68) D		
(39-54) E		
(21-38) F		
(1-20) G		
Not energy efficient - higher running costs		
England & Wales	EU Directive 2002/91/EC	



TAYLOR GIBBS

Residential Sales, Lettings & Management Agents

33 Highgate High Street, Highgate, London, N6 5JT

Tel: 020 8341 0123

enquiries@taylorgibbs.co.uk

www.taylorgibbs.co.uk

