



**67 Greenshields Road,
Bedford MK40 3TU**

**Taylor
Brightwell**



A 1930's three bedroom detached house with a 72 ft west facing garden nicely situated on this highly desirable road within the Castle Quarter providing convenient access to the town centre, the mainline railway station, The Embankment and excellent local schools.

The property has many character features throughout and the spacious accommodation includes the bay fronted sitting room, a separate dining room, a conservatory, a cloakroom and a fitted kitchen. The first floor has the three well proportioned bedrooms and the family bathroom.

Externally there is a walled front garden and a driveway leading to the single garage and a private 72 ft x 30 ft west facing rear garden.

This excellent family home in this much sought after location offers great potential and scope to extend (STPP) and is offered for sale with no upward chain. Viewing is highly recommended.

- * **3 Bedroom Detached**
- * **2 Reception Rooms**
- * **Cloakroom**
- * **Conservatory**
- * **Gas Radiator Heating**
- * **Double Glazed**
- * **72 Ft West Facing Rear Garden**
- * **Character Features**
- * **Much Sought After Location**
- * **No Upward Chain**

Freehold



"Hassett House", Hassett Street, Bedford MK40 1HA

www.taylorbrightwell.co.uk property@taylorbrightwell.co.uk

01234 326444

Money Laundering Regulations: Intending purchasers will be asked to produce identification documentation and we would ask for co-operation in order that there is no delay in agreeing a sale. Agents Notes: The agent has not tested any apparatus, equipment, fixtures & fittings or services and so cannot verify that they are in working order or fit for the purpose. A buyer is advised to obtain verification from their solicitor or surveyor. All photographs shown are for illustration purposes only and may depict items that are not for sale or included in the sale of the property. Please note that we have not checked the situation with regards to planning consents, building regulation consents and any other relevant consents relating to this property and therefore, any interested purchaser should carry out their own enquiries with the appropriate authorities. All measurements are approximate and for guidance only. The particulars do not form part of any contract and all properties are offered subject to contract. Neither Taylor Brightwell nor any of its employees or agents has any authority to make or give any representation or warranty whatsoever in relation to this property.

67, Greenshields Road, Bedford, Bedfordshire, MK40 3TU

APPROX. GROSS INTERNAL FLOOR AREA 1327 SQ FT 123.2 SQ METRES (INCLUDES DETACHED GARAGE)

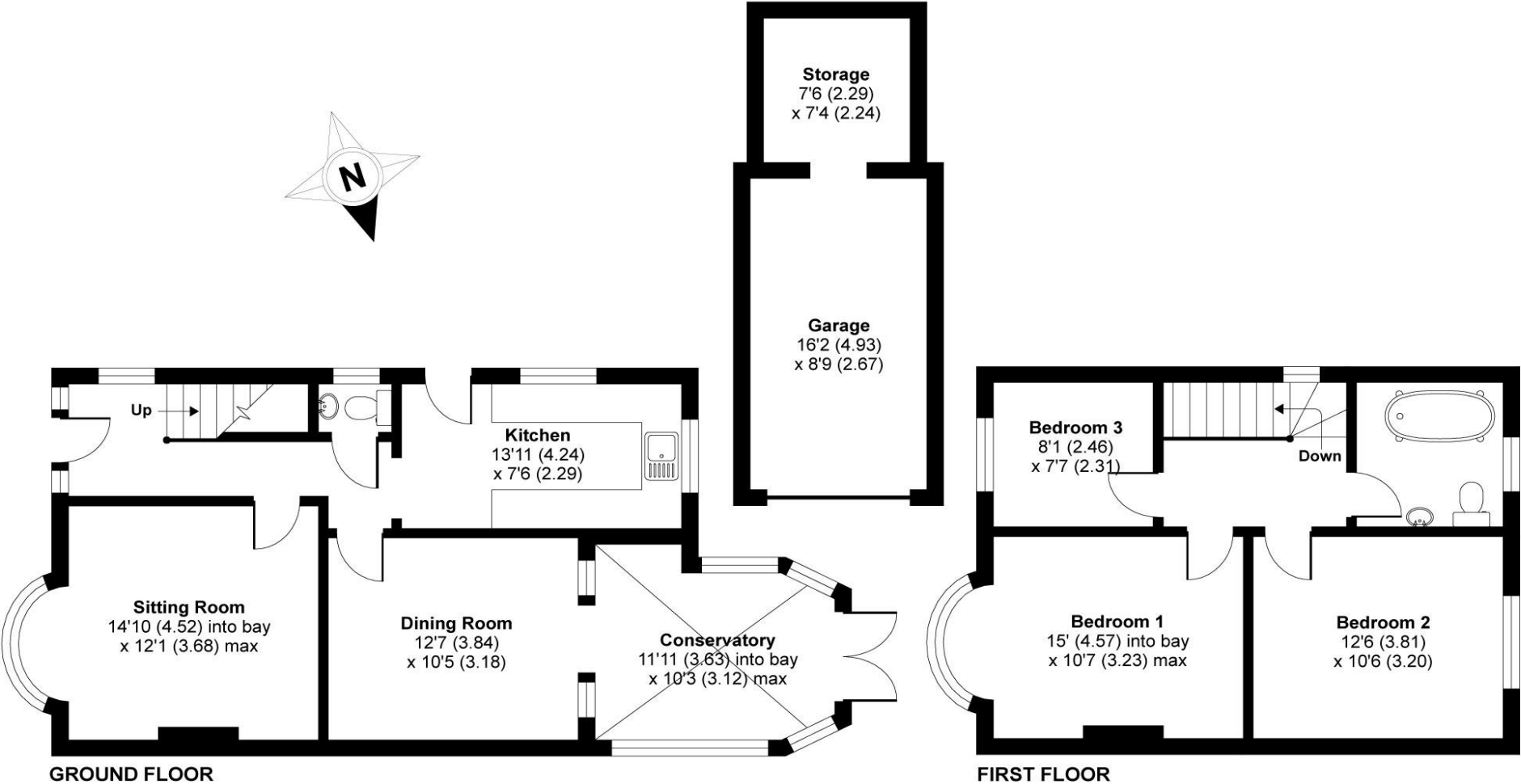

Whilst every attempt has been made to ensure the accuracy of the floor plan contained here, measurements of doors, windows and rooms are approximate and no responsibility is taken for any error, omission or misstatement. These plans are for representation purposes only as defined by RICS Code of Measuring Practice and should be used as such by any prospective purchaser. Specifically no guarantee is given on the total square footage of the property if quoted on this plan. Any figure given is for initial guidance only and should not be relied on as a basis of valuation.