



FOR SALE  
Taylor  
Brightwell  
(01234) 326444

**“The Nest” 125 Stagsden Road,  
Bromham, Bedfordshire, MK43 8QJ**

**Taylor  
Brightwell**







A very light, airy and well maintained, three/four bedroom detached house with an established private rear garden, positioned within easy reach of local amenities within the highly regarded north Bedfordshire village of Bromham.

The nicely presented and versatile accommodation includes an entrance hall with wooden flooring, a refitted cloakroom, a spacious sitting/dining room and two double sized ground floor bedrooms including the main bedroom with its walk in wardrobe and modern ensuite shower room. There is a good sized kitchen with a comprehensive range of units, a utility room with plumbing for washing machine and tumble/dryer plus a spacious conservatory with double doors leading to the garden. The first floor has a bright landing with two double bedrooms, and the modern family bathroom.

Outside the property benefits from an enclosed front garden which has a driveway area with parking for 2/3 cars and a further driveway leading to the oversized garage. To the rear there is a 69 ft x 39 ft private garden with a lawn, a patio and well stocked, established borders.

A well cared for home with a lovely garden close to local amenities and offering great versatility. Viewing is highly recommended.

- \* **3/4 Good Sized Bedrooms**
- \* **2 Reception Rooms**
- \* **Cloakroom**
- \* **Conservatory**
- \* **Double Glazing**
- \* **Gas Radiator Heating**
- \* **Private Established Rear Garden**
- \* **Garage & Driveway**
- \* **Well Maintained Throughout**

**Freehold**



"Hassett House", Hassett Street, Bedford MK40 1HA

[www.taylorbrightwell.co.uk](http://www.taylorbrightwell.co.uk)    [property@taylorbrightwell.co.uk](mailto:property@taylorbrightwell.co.uk)

**01234 326444**

Money Laundering Regulations: Intending purchasers will be asked to produce identification documentation and we would ask for co-operation in order that there is no delay in agreeing a sale. Agents Notes: The agent has not tested any apparatus, equipment, fixtures & fittings or services and so cannot verify that they are in working order or fit for the purpose. A buyer is advised to obtain verification from their solicitor or surveyor. All photographs shown are for illustration purposes only and may depict items that are not for sale or included in the sale of the property. Please note that we have not checked the situation with regards to planning consents, building regulation consents and any other relevant consents relating to this property and therefore, any interested purchaser should carry out their own enquiries with the appropriate authorities. All measurements are approximate and for guidance only. The particulars do not form part of any contract and all properties are offered subject to contract. Neither Taylor Brightwell nor any of its employees or agents has any authority to make or give any representation or warranty whatsoever in relation to this property.

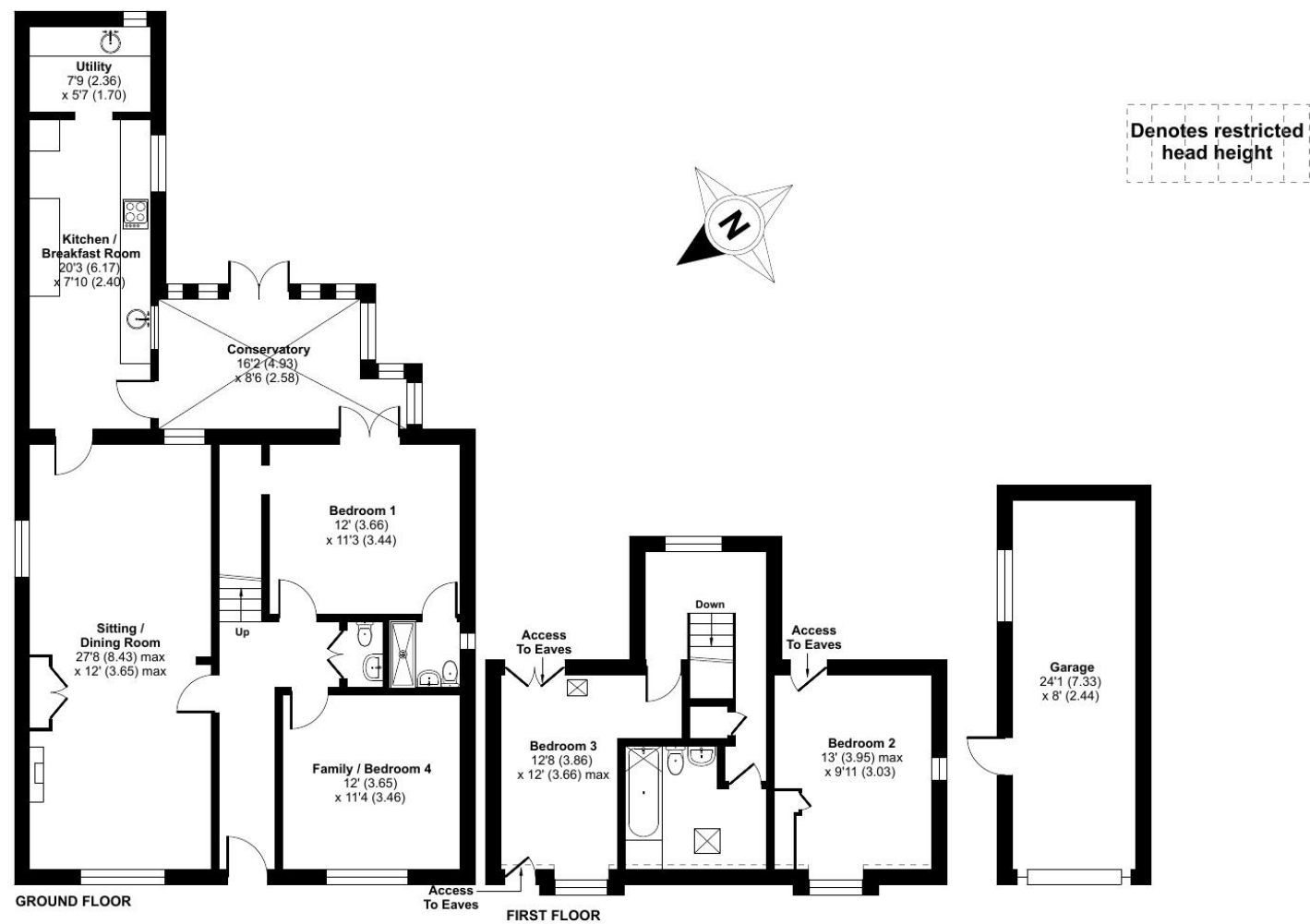

Approximate Area = 1547 sq ft / 143.7 sq m  
Limited Use Area(s) = 7 sq ft / 0.6 sq m  
Garage = 193 sq ft / 17.9 sq m  
Total = 1747 sq ft / 162.2 sq m

For identification only - Not to scale



Floor plan produced in accordance with RICS Property Measurement 2nd Edition, Incorporating International Property Measurement Standards (IPMS2 Residential). © nichecom 2025. Produced for Taylor Brightwell. REF: 1394386