



97, Poppyfields,
Bedford MK41 0TW

Taylor
Brightwell



A well presented two bedroom end of terrace house situated within a small close approximately three miles from the town centre with a choice of nearby shops and supermarkets, local schools and excellent road links.

The property benefits from replacement UPVC double glazing, gas radiator heating, a refitted kitchen/diner with a good range of stylish units and an integrated oven, a spacious lounge, two double bedrooms and a refitted bathroom. Outside there is a fully enclosed 31 ft west facing rear garden and an open plan front garden with off road parking for two cars.

An ideal first time buy or investment property, viewing is highly recommended.

- * **2 Double bedrooms**
- * **Refitted kitchen/diner**
- * **Spacious lounge**
- * **UPVC double glazing**
- * **West facing rear garden**
- * **Parking for 2 cars**
- * **Ideal first time buy**

FREEHOLD



"Hassett House", Hassett Street, Bedford MK40 1HA

www.taylorbrightwell.co.uk property@taylorbrightwell.co.uk

01234 326444

Money Laundering Regulations: Intending purchasers will be asked to produce identification documentation and we would ask for co-operation in order that there is no delay in agreeing a sale. Agents Notes: The agent has not tested any apparatus, equipment, fixtures & fittings or services and so cannot verify that they are in working order or fit for the purpose. A buyer is advised to obtain verification from their solicitor or surveyor. All photographs shown are for illustration purposes only and may depict items that are not for sale or included in the sale of the property. Please note that we have not checked the situation with regards to planning consents, building regulation consents and any other relevant consents relating to this property and therefore, any interested purchaser should carry out their own enquiries with the appropriate authorities. All measurements are approximate and for guidance only. The particulars do not form part of any contract and all properties are offered subject to contract. Neither Taylor Brightwell nor any of its employees or agents has any authority to make or give any representation or warranty whatsoever in relation to this property.

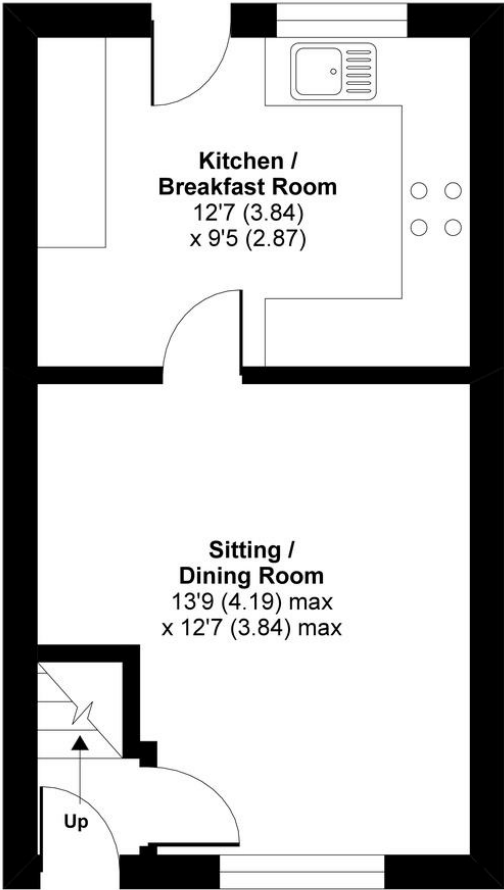

GROUND FLOOR

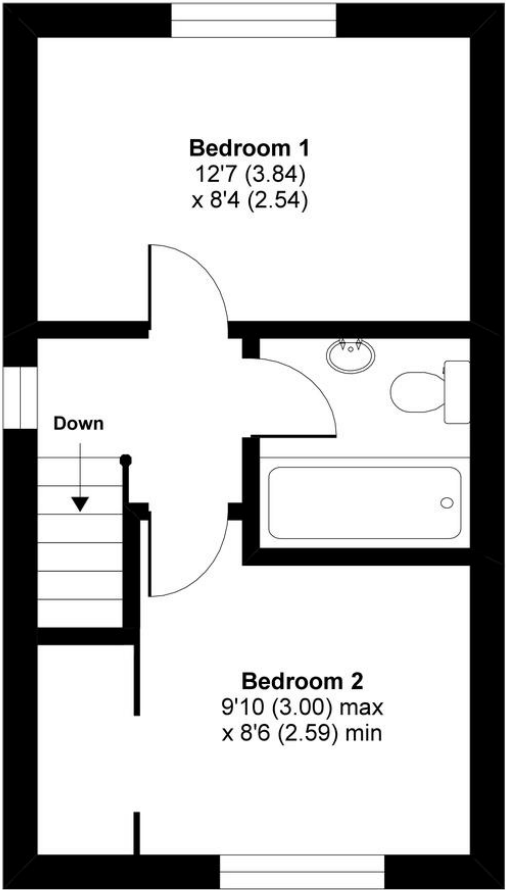

FIRST FLOOR



Approximate Area = 604 sq ft / 56.1 sq m

For identification only - Not to scale



Floor plan produced in accordance with RICS Property Measurement Standards incorporating International Property Measurement Standards (IPMS2 Residential). © n1che.com 2020. Produced for Taylor Brightwell. REF: 656782