



**65a Silver Street, Great Barford
Bedfordshire MK44 3JA**

**Taylor
Brightwell**



A spacious two double bedroom detached bungalow situated in the attractive and highly desirable riverside village of Gt Barford which provides easy access to the A1 and the market towns of Bedford, St Neots and Sandy, all with mainline train stations.

The property will require some modernisation and upgrading and includes a large inner reception hall, a separate sitting room with access to the lean-to conservatory and garden beyond, a good sized fitted kitchen/breakfast room, the two double bedrooms, a three piece bathroom plus a cloakroom.

The rear garden is private and fully enclosed with a southerly aspect and is approximately 32 ft x 31 ft laid to lawn and with gated pedestrian access to the front.

Gt Barford is very popular village with an attractive river frontage and has many amenities including a primary school, a church, village hall, pub/restaurant, shop and post office and a choice of sports and recreational facilities.

Offered for sale with no upward chain.

- * **2 Double Bedrooms**
- * **Good Sized Sitting Room**
- * **Kitchen/Breakfast Room**
- * **Double Glazing**
- * **Gas Radiator Heating**
- * **Garage**
- * **South Facing Rear Garden**
- * **Modernisation Required**
- * **Sought After Village Location**
- * **No Upward Chain**

FREEHOLD



“Hassett House”, Hassett Street, Bedford MK40 1HA

www.taylorbrightwell.co.uk property@taylorbrightwell.co.uk

01234 326444

Money Laundering Regulations: Intending purchasers will be asked to produce identification documentation and we would ask for co-operation in order that there is no delay in agreeing a sale. Agents Notes: The agent has not tested any apparatus, equipment, fixtures & fittings or services and so cannot verify that they are in working order or fit for the purpose. A buyer is advised to obtain verification from their solicitor or surveyor. All photographs shown are for illustration purposes only and may depict items that are not for sale or included in the sale of the property. Please note that we have not checked the situation with regards to planning consents, building regulation consents and any other relevant consents relating to this property and therefore, any interested purchaser should carry out their own enquiries with the appropriate authorities. All measurements are approximate and for guidance only. The particulars do not form part of any contract and all properties are offered subject to contract. Neither Taylor Brightwell nor any of its employees or agents has any authority to make or give any representation or warranty whatsoever in relation to this property.

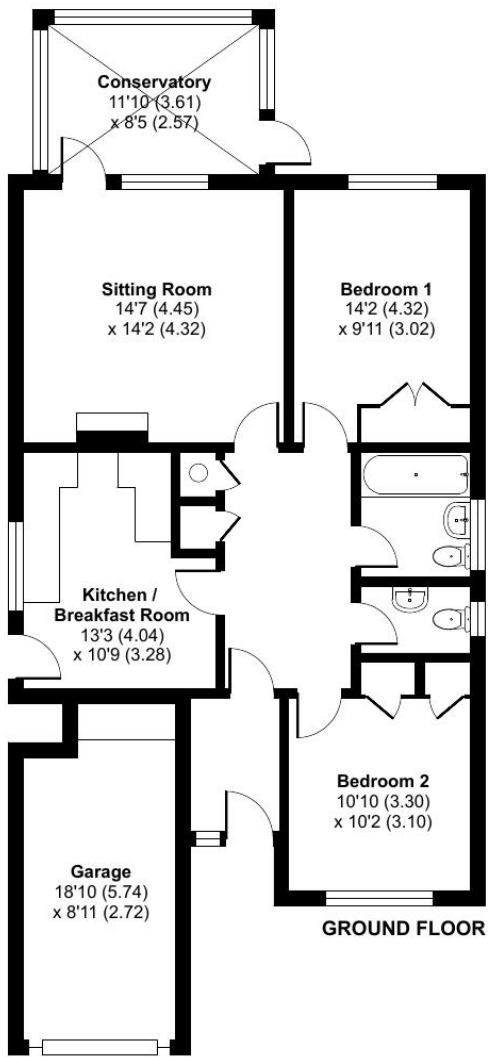

Approximate Area = 967 sq ft / 89.8 sq m (excludes garage)

For identification only - Not to scale



Floor plan produced in accordance with RICS Property Measurement Standards incorporating International Property Measurement Standards (IPMS2 Residential). © n1checom 2023. Produced for Taylor Brightwell. REF: 994064