

Boundary Treatment

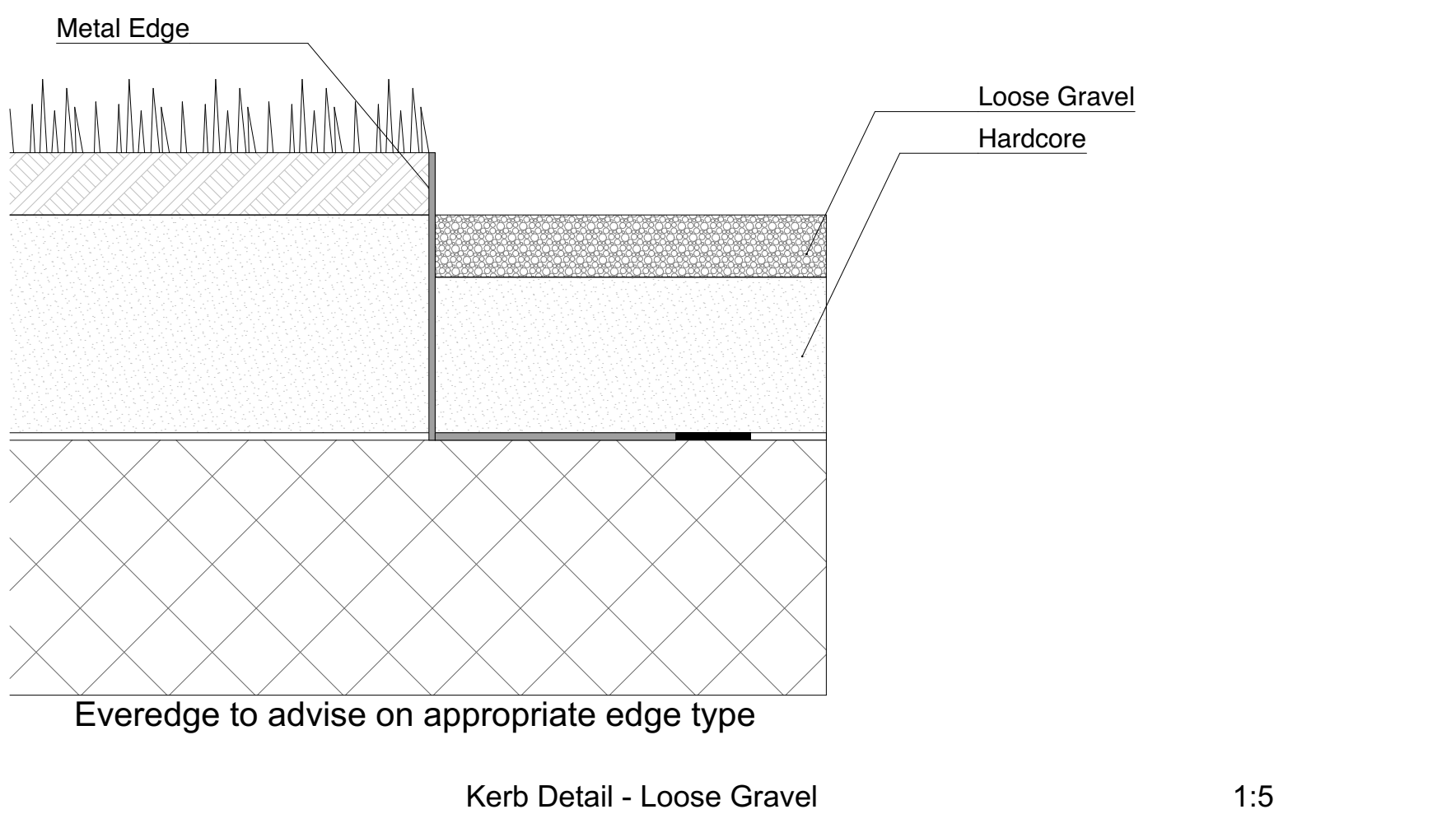
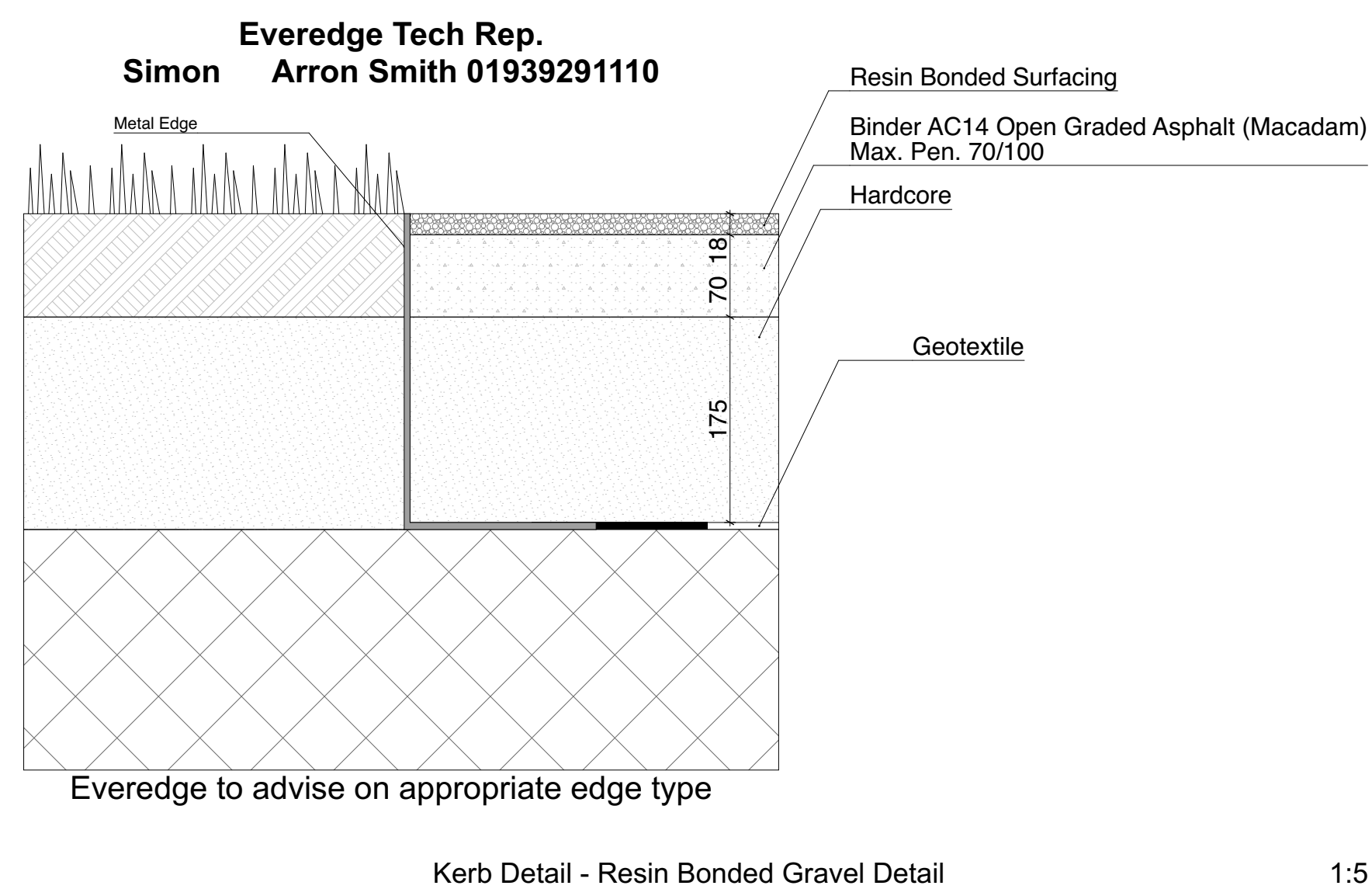
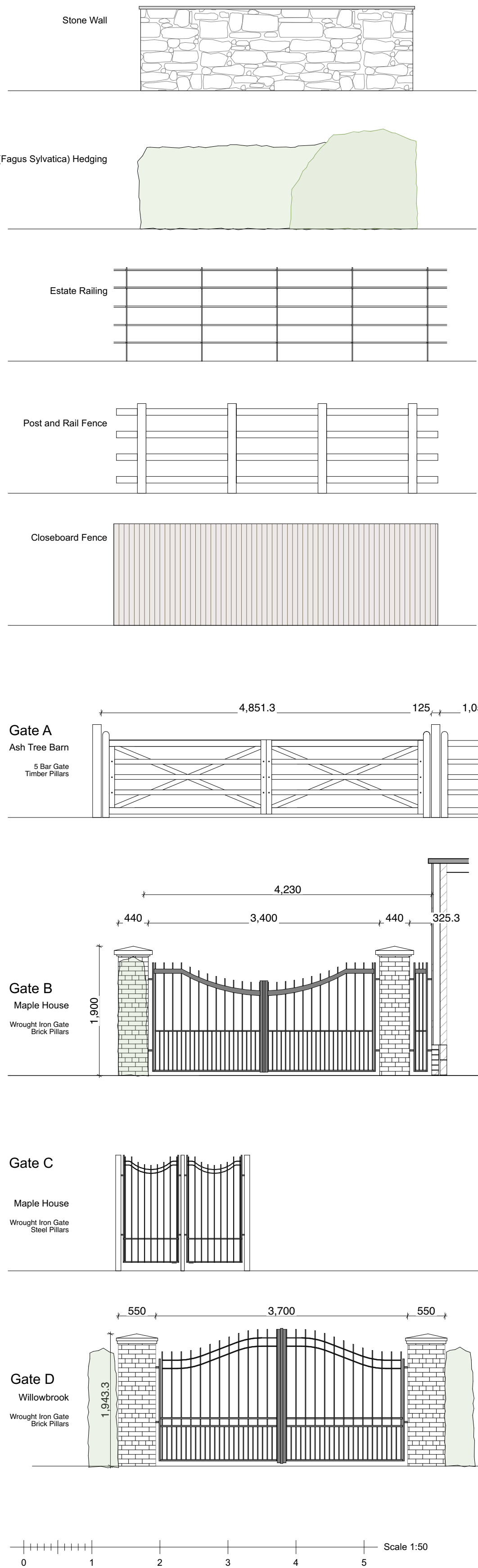

*** All Gate Locations to be Approved by Clients on Site**

General Notes

1. This drawing is to be read in conjunction with all relevant engineers and specialists drawings and specification. Any discovered discrepancies discovered between drawings are to be reported to DuCroz architects.
2. Health and Safety - All specific drawings notes are to be read in conjunction with the project health and safety documentation.
3. Do not scale from this drawing in either paper or digital form. Use written dimensions only. All dimensions are in millimetres.
4. To check the drawing has been printed at the intended scale this line should be 50mm long at A1 or 25mm at A3

Issue: Design Revision

Revision	Date
C2.2	DD.MM.YY
P2.7	DD.MM.YZ
C3	29.04.2021

- Gravel Drive
- Grass
- Paving
- New Trees
- Existing Trees
- RPA (Root Protection Area)
- Stone Wall
- Post and Rail Fence
- Estate Railings
- Close Boarded Fence
- Hedge
- Line of Roof Overhead
- Approved Position of House



The Wool Loft
10 Spinners Court
53 West End
Witney
Oxfordshire
OX28 1NH
01993 709035
www.ducroz.co.uk

Project: The Woodlands
Reference: DC081
Client: Mr & Mrs Taylor

Issued: 30/07/2020
Status: Design Revision
Scale: 1:200, 1:50, 1:5@A1

Proposed Site Plan