

Dallow Road | Luton



venture
residential



Offers Over £105,000

Are you a first time buyer looking to get onto the property ladder? Or an investor looking to add to your portfolio?
Call us today to arrange a viewing on 01582 249155.

01582 249155

www.venture-residential.co.uk

Description

Venture Residential are pleased to bring to the market this one bedroom ground floor maisonette in the Dallow Road area of Luton.

This home is within walking distance of local shops and schools. The property is located on a bus route which will take you to the local town centre where you can find a range of shops and eateries as well as the main train station where you get direct links into London.

This property briefly comprises a porch, entrance hall lounge/diner, kitchen, great size bedroom and bathroom.

The Leasehold has approximately 97 years left.

This property would be ideal for a first time buyer or someone who is looking for an investment.

Call us today to arrange a viewing on 01582 249155



Ground floor

Entrance Porch

Double glazed door and window to front aspect.

Lounge 13' 9" x 10' 6" (4.2m x 3.2m)

Double glazed window to front aspect and gas wall heater.

Kitchen 5' 3" x 7' 10" (1.6m x 2.4m)

Fitted kitchen with a range of wall and base units with work surfaces, stainless steel sink unit, splash back tiling, electric oven and plumbing for washing machine.

Bedroom 10' 2" x 9' 2" (3.1m x 2.8m)

Double glazed window to rear aspect, fitted wardrobes and gas wall heater.

Bathroom

Bath, pedestal wash hand basin, low level WC and part tiled.

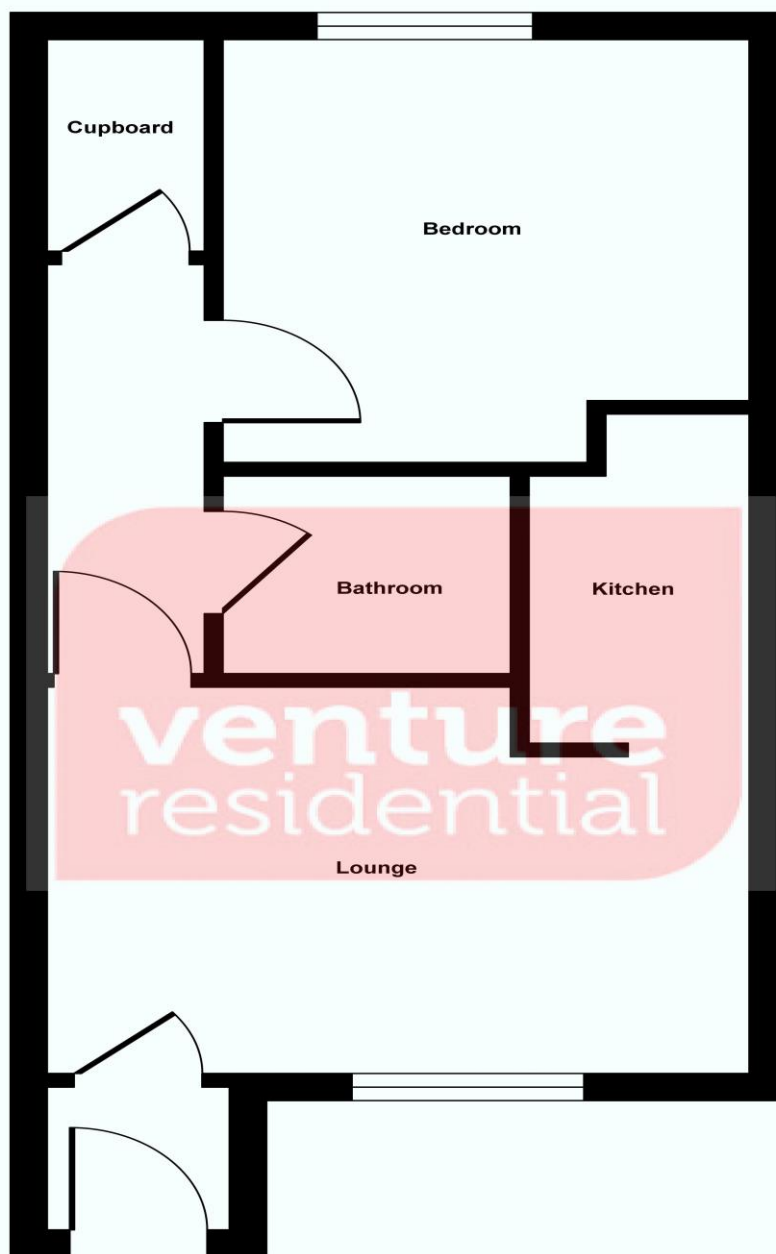

Floor Plan

Illustration for identification purposes only, measurements are approximate, not to scale.
Produced by Elements Property



Venture Residential

Leagrave Train Station 9 Compton Avenue Luton Bedfordshire LU4 9AX

{agency_phone}

{agency_url}