



**venture**  
RESIDENTIAL

Dumfries Street, Luton, Bedfordshire, LU1 5BU

Price £185,000 Leasehold



Nestled in the heart of Luton, this ground-floor 2-bedroom residence on Dumfries Street beckons with its modern charm and strategic location. A mere stone's throw from the bustling Luton Town Centre and within walking distance to the train station.





# Dumfries Street

Luton, LU1 5BU



- 2 Bedroom Flat
- Close to Town Centre
- Walking distance to train station
- Own Entrance



Dumfries Street, Luton, this charming 2-bedroom ground floor property awaits. Conveniently located in close proximity to Luton Town Centre, and within easy walking distance to the train station, this residence seamlessly blends comfort with urban accessibility.

As you step into this inviting home, you are welcomed into a cozy haven that exudes warmth. The well-designed layout features two bedrooms, offering an ideal space for a small family, professionals, or those seeking a conveniently located pied-à-terre.

The proximity to Luton Town Centre ensures that daily necessities, shopping, and entertainment options are within easy reach. The vibrant local atmosphere adds to the appeal, making it a desirable locale for those who appreciate the energy of urban living.

The property's advantageous location also means that the train station is just a stroll away. Commuting to neighbouring areas, including London, becomes a seamless experience, catering to the needs of those with busy lifestyles or work commitments.

The ground floor setting adds an extra layer of convenience, allowing for easy access and a fluid connection between indoor and outdoor spaces. Whether you're enjoying a quiet evening in or stepping out for a leisurely stroll, the property effortlessly accommodates various lifestyle preferences.

Dumfries Street beckons as more than just an address; it represents a lifestyle choice. The blend of comfort, accessibility, and urban charm make this 2-bedroom ground floor property an attractive option for those seeking a delightful home in the heart of Luton. Don't miss the opportunity to make Dumfries Street your home and experience the best of town centre living.

GROUND FLOOR

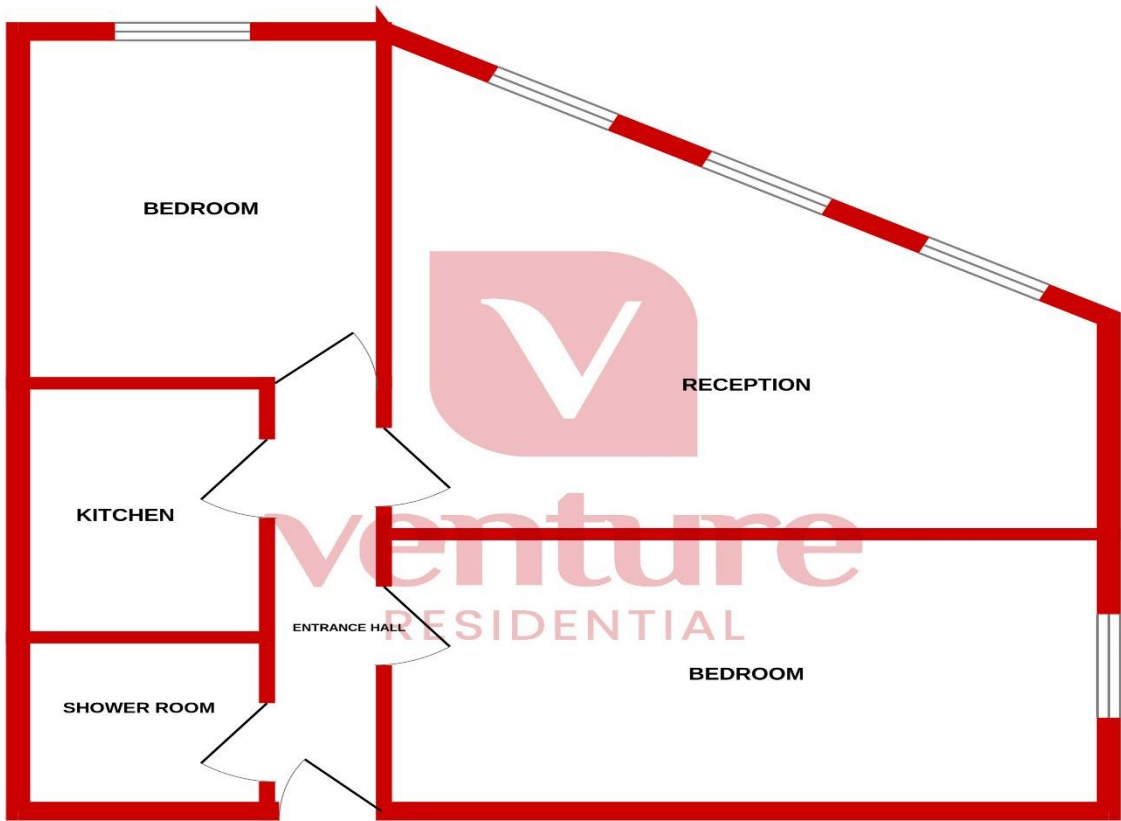

Whilst every attempt has been made to ensure the accuracy of the floorplan contained here, measurements of doors, windows, rooms and any other items are approximate and no responsibility is taken for any error, omission or mis-statement. This plan is for illustrative purposes only and should be used as such by any prospective purchaser. The services, systems and appliances shown have not been tested and no guarantee as to their operability or efficiency can be given.  
Made with Metropix ©2024

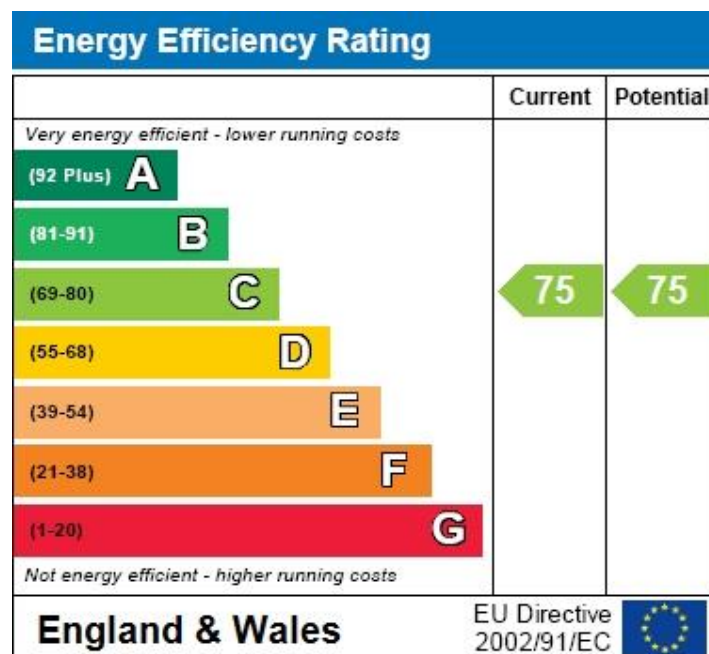

## Notice

Please note we have not tested any apparatus, fixtures, fittings, or services. Interested parties must undertake their own investigation into the working order of these items. All measurements are approximate and photographs provided for guidance only.



**9 Compton Avenue,  
Luton,  
Bedfordshire,  
LU4 9AX**

**T: 01582 249155  
E: [info@venture-residential.co.uk](mailto:info@venture-residential.co.uk)**

