



Townsend Mews, Stevenage, Hertfordshire, SG1 3AT

Price £225,000 Leasehold



A charming 1-bedroom split-level maisonette nestled in the heart of the popular high street area of Old Stevenage. This well-appointed residence offers a blend of modern convenience and comfortable living, making it an ideal choice for both first-time buyers and investors alike.



Townsend Mews

Stevenage, SG1 3AT



- Located on High Street, Old Town Stevenage
- Gated Development
- Walking Distance to Stevenage Train Station
- Great Proximity to the A1
- Ideal for first time buyer or Investor
- Presented in fantastic condition



Upon entering, you are greeted by a bright and inviting open-plan layout encompassing the kitchen, lounge, and diner. This versatile space is perfect for entertaining guests or relaxing after a long day. The kitchen area features modern appliances and ample counter space, making meal preparation a breeze.

Ascending to the upper level, you'll find a generously sized bedroom adorned with fitted wardrobes, providing plenty of storage space for your belongings. Natural light floods the room, creating a serene atmosphere conducive to rest and relaxation.

Convenience is key at Townsend Mews, as the property is conveniently located just a short walk away from Stevenage Train Station, offering excellent transport links for commuters. Additionally, easy access to the A1 motorway ensures seamless connectivity to nearby towns and cities.

For added convenience, the property comes with one allocated parking space, eliminating the hassle of searching for parking in the bustling high street area.

In summary, Townsend Mews presents an exceptional opportunity to own a stylish and well-situated property in the heart of Old Stevenage. Whether you're taking your first step onto the property ladder or seeking a lucrative investment opportunity, this maisonette ticks all the boxes for modern urban living. Don't miss your chance to make this delightful residence your own. Schedule a viewing today!

GROUND FLOOR

1ST FLOOR

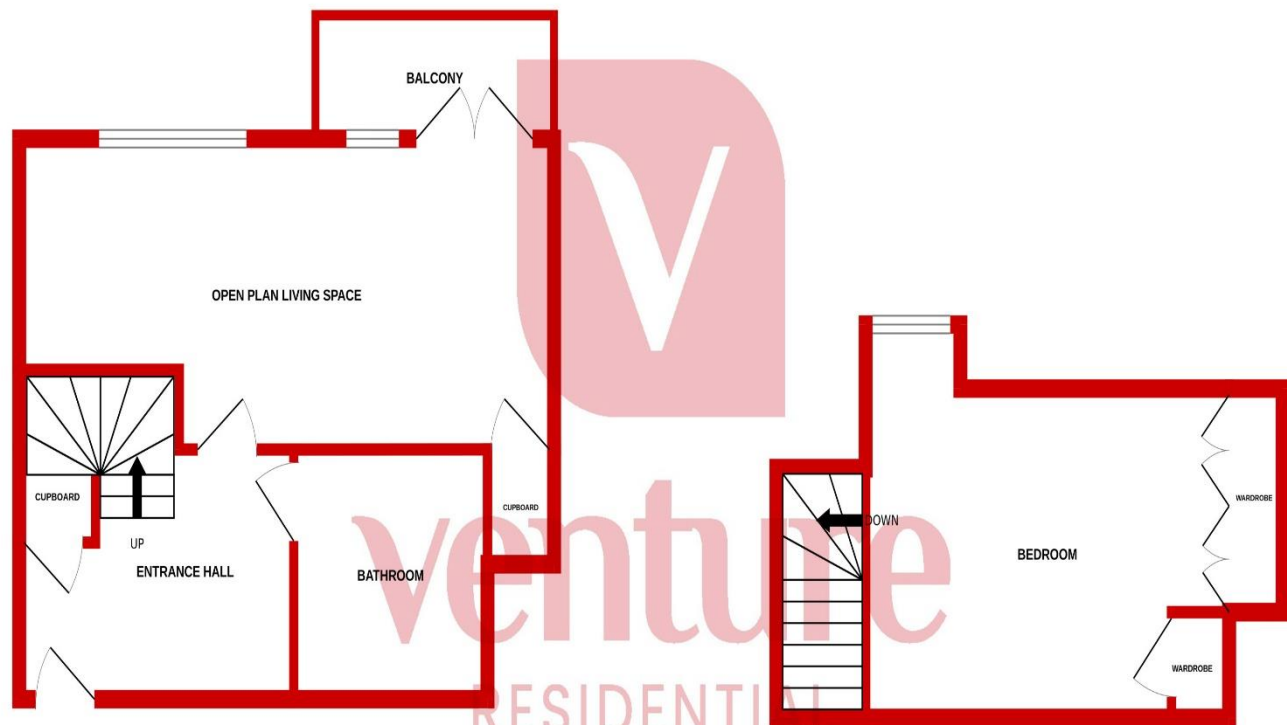

Whilst every attempt has been made to ensure the accuracy of the floorplan contained here, measurements of doors, windows, rooms and any other items are approximate and no responsibility is taken for any error, omission or mis-statement. This plan is for illustrative purposes only and should be used as such by any prospective purchaser. The services, systems and appliances shown have not been tested and no guarantee as to their operability or efficiency can be given.
Made with Metropix ©2024

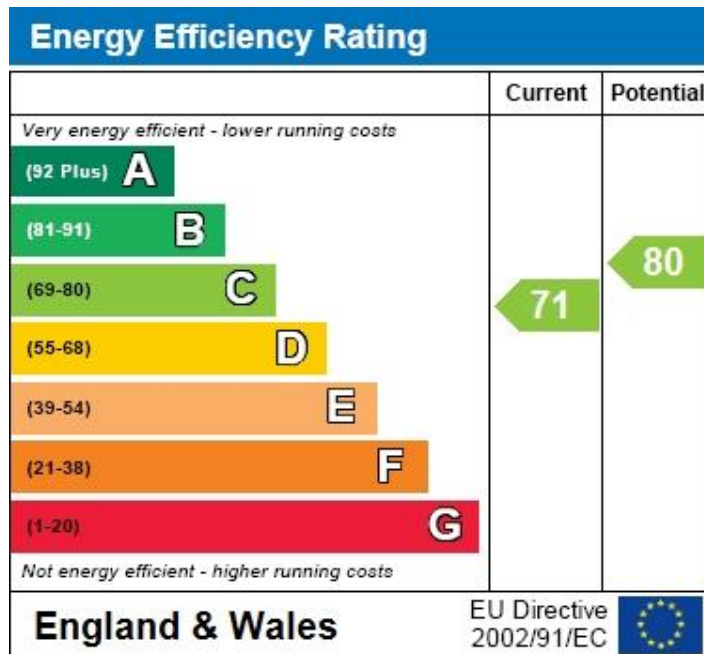

Notice

Please note we have not tested any apparatus, fixtures, fittings, or services. Interested parties must undertake their own investigation into the working order of these items. All measurements are approximate and photographs provided for guidance only.



**9 Compton Avenue,
Luton,
Bedfordshire,
LU4 9AX**

**T: 01582 249155
E: info@venture-residential.co.uk**

