



Turners Road South, Luton, Bedfordshire, LU2 0PH
Price Offers in Excess of £375,000 Freehold



Venture Residential is delighted to present this impressive three-bedroom house, which has been thoughtfully extended to provide ample living space.



Turners Road South

Luton, LU2 0PH



- Spacious and extended three bedroom semi detached home
- Two reception areas
- Modern kitchen with appliances
- Dining area
- Utility room and a garage
- Off road parking for multiple vehicles
- Being offered without the complications of an onward chain
- Lovely rear garden



Venture Residential is delighted to present this impressive three-bedroom house, which has been thoughtfully extended to provide ample living space. Located on Turners Road South in Luton, this beautifully upgraded home offers modern comforts and a welcoming atmosphere, making it an ideal choice for families and professionals alike.

As you enter the property, you are greeted by a spacious and elegantly designed lounge area that provides the perfect space for relaxation and entertaining guests. The large windows allow for plenty of natural light, creating a bright and airy ambience throughout. The home features a second lounge, adding versatility and additional space for a family room, study, or play area.

The kitchen is well-equipped with high-quality appliances and ample storage, making it a practical and stylish space for culinary enthusiasts. Adjacent to the kitchen, the dining area provides a warm and inviting setting for family meals or hosting dinner parties. A separate utility room adds convenience, ensuring household tasks can be managed with ease.

This home boasts modern bathrooms with sleek fixtures and fittings, designed for comfort and luxury. The bedrooms are generously sized, providing plenty of space for furnishings and personal touches. Each room has been decorated to complement the contemporary feel of the property, ensuring a stylish yet cozy environment for its residents.

The outdoor space is equally impressive, featuring a spacious garden that offers ample room for outdoor activities, gardening, or simply unwinding in a private setting. Whether you are looking to host summer barbecues or create a play area for children, this garden provides endless possibilities. The property also benefits from off-road parking with space to accommodate up to four cars, a rare and valuable feature in this sought-after area.

Situated in a prime location, this home is ideal for families due to its proximity to excellent schools and local parks. The neighbourhood is known for its welcoming community and family-friendly environment, making it a highly desirable place to live. Additionally, the area offers great transport links, ensuring easy access to nearby amenities and the wider Luton area.

This stunning property is available chain-free, providing a hassle-free purchasing opportunity for buyers looking to move quickly. If you are searching for a spacious, modern, and well-located home, this property on Turners Road South is not to be missed.

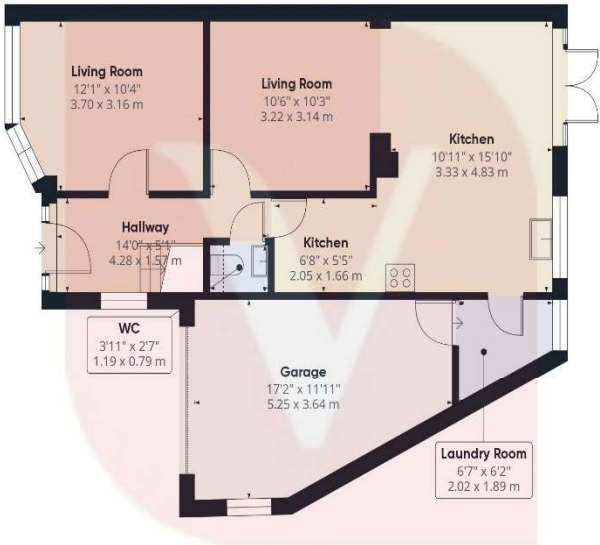

Approximate total area⁽¹⁾
1081.14 ft²
100.44 m²

Reduced headroom
2.05 ft²
0.19 m²

(1) Excluding balconies and terraces

Reduced headroom
----- Below 5 ft/1.5 m

While every attempt has been made to ensure accuracy, all measurements are approximate, not to scale. This floor plan is for illustrative purposes only.

Calculations were based on RICS IPMS 3C standard. Please note that calculations were adjusted by a third party and therefore may not comply with RICS IPMS 3C.

GIRAFFE360



Energy Efficiency Rating		
	Current	Potential
Very energy efficient - lower running costs		
(92 Plus) A		
(81-91) B		84
(69-80) C		
(55-68) D	63	
(39-54) E		
(21-38) F		
(1-20) G		
Not energy efficient - higher running costs		
England & Wales	EU Directive 2002/91/EC	



Notice

Please note we have not tested any apparatus, fixtures, fittings, or services. Interested parties must undertake their own investigation into the working order of these items. All measurements are approximate and photographs provided for guidance only.



9 Compton Avenue,
Luton,
Bedfordshire,
LU4 9AX

T: 01582 249155
E: info@venture-residential.co.uk

