



Tavistock Crescent, Luton, Bedfordshire, LU1 3UP

Price £270,000 Freehold



Venture Residential are delighted to bring to the market this three bedroom mid-terrace home on Tavistock Crescent, located in the heart of Luton town centre. This property is a great opportunity for buyers looking to put their own stamp on a home or for investors wanting to add to their portfolio.



Tavistock Crescent

Luton, LU1 3UP



- Three-bedroom mid terrace
 - On street parking
- Two separate reception rooms
 - Spacious bedrooms
 - Currently let at £1500
 - Town centre location



Venture Residential are delighted to bring to the market this three-bedroom mid-terrace home on Tavistock Crescent, located in the heart of Luton town centre. This property is a great opportunity for buyers looking to put their own stamp on a home or for investors wanting to add to their portfolio.

The property is in need of modernisation, offering lots of potential to improve and add value. On the ground floor, you'll find two separate reception rooms, which can be used as a lounge and dining area, along with a kitchen at the rear that leads out to the garden.

Upstairs, the home benefits from three double bedrooms, providing plenty of space for a growing family or for tenants. There is also a shower room on the first floor.

Outside, there is a small private rear garden, ideal for relaxing or light gardening. On-street permit parking is available for residents.

One of the key features of this property is its central location. Being in the town centre means you are just a short walk from local shops, supermarkets, schools, and other amenities. Luton train station and the University of Bedfordshire are also nearby, making this a great spot for commuters, students, and professionals.

The property is currently let at £1,500 per month, offering an immediate income for investors. With some updating, there is also potential to increase the rental value or future resale price.



Approximate total area⁽¹⁾
761 ft²
70.7 m²

(1) Excluding balconies and terraces

Calculations reference the RICS IPMS 3C standard. Measurements are approximate and not to scale. This floor plan is intended for illustration only.

GIRAFFE360

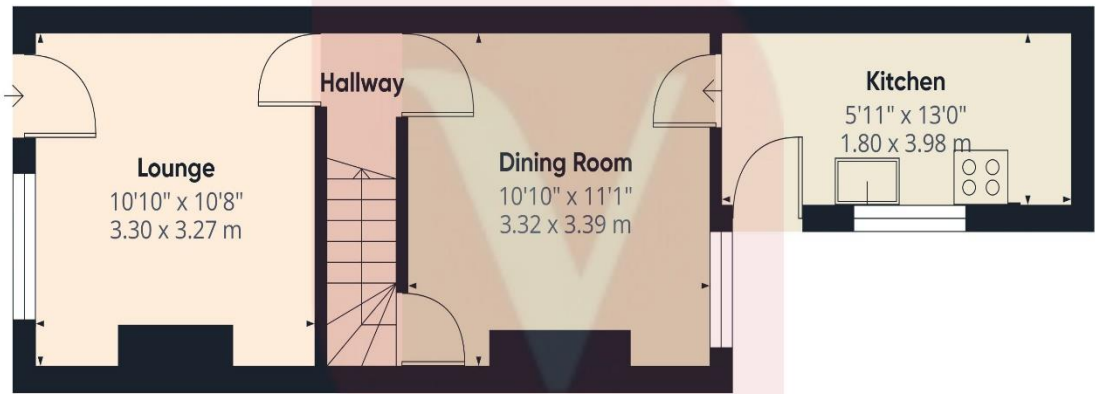

Ground Floor

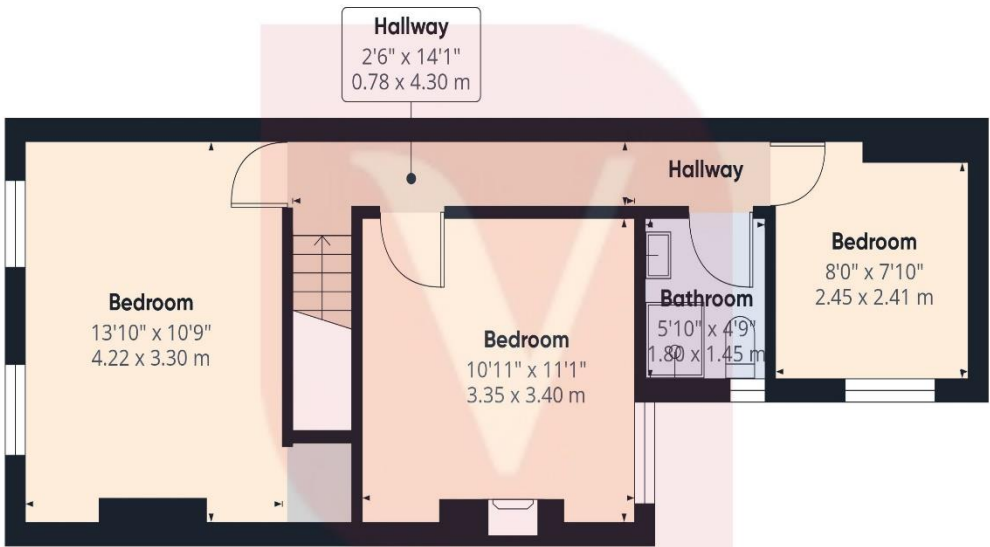

Floor 1

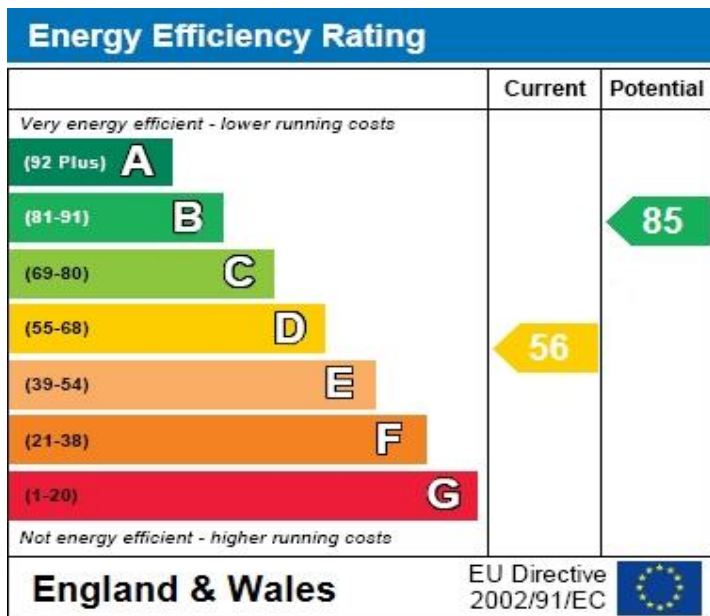

Notice

Please note we have not tested any apparatus, fixtures, fittings, or services. Interested parties must undertake their own investigation into the working order of these items. All measurements are approximate and photographs provided for guidance only.



**9 Compton Avenue,
Luton,
Bedfordshire,
LU4 9AX**

**T: 01582 249155
E: info@venture-residential.co.uk**

