



King Henry Court, Tudor Road, Luton, Bedfordshire, LU3 1RN

Price £120,000 Leasehold



This one-bedroom flat is located in the ever-popular Biscot area of Luton, set within a small and well-maintained private development just off Tudor Road.



Tudor Road

Luton, LU3 1RN



- Double bedroom with mirrored fitted wardrobes
- Integrated appliances included
- Open-plan kitchen/living area with breakfast bar
- Ideal for first-time buyers and investors
- Tucked away in a peaceful development
- Modern three-piece bathroom suite

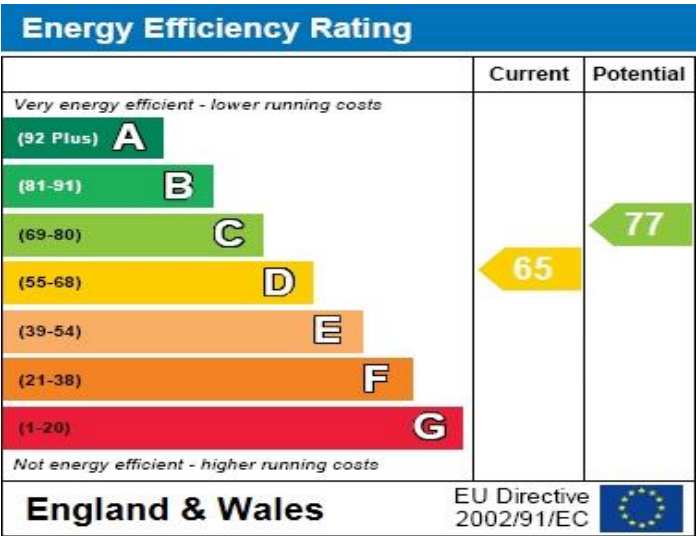

This one-bedroom flat is located in the ever-popular Biscot area of Luton, set within a small and well-maintained private development just off Tudor Road. Offering both style and convenience, the property would make a fantastic choice for a first-time buyer looking to step onto the property ladder, or an investor seeking a buy-to-let opportunity in a desirable location.

Internally, the home has been designed to maximise both space and practicality.

The heart of the property is the open-plan kitchen and living area, complete with a stylish breakfast bar and built-in appliances, making it the perfect space to cook, dine, and relax. The spacious double bedroom is enhanced by mirrored fitted wardrobes, providing both storage and a modern finish. Completing the accommodation is a contemporary three-piece bathroom suite.

The Biscot area is well regarded for its strong community feel and excellent access to local amenities. The property benefits from being within easy reach of Luton town centre, Luton railway station (providing direct trains into London St Pancras), as well as a range of shops, restaurants, and leisure facilities. For those travelling further afield, the M1 motorway and London Luton Airport are also just a short drive away.

With its fantastic location and well-presented accommodation, this flat is ready to move straight into and is certain to attract strong interest.

GROUND FLOOR

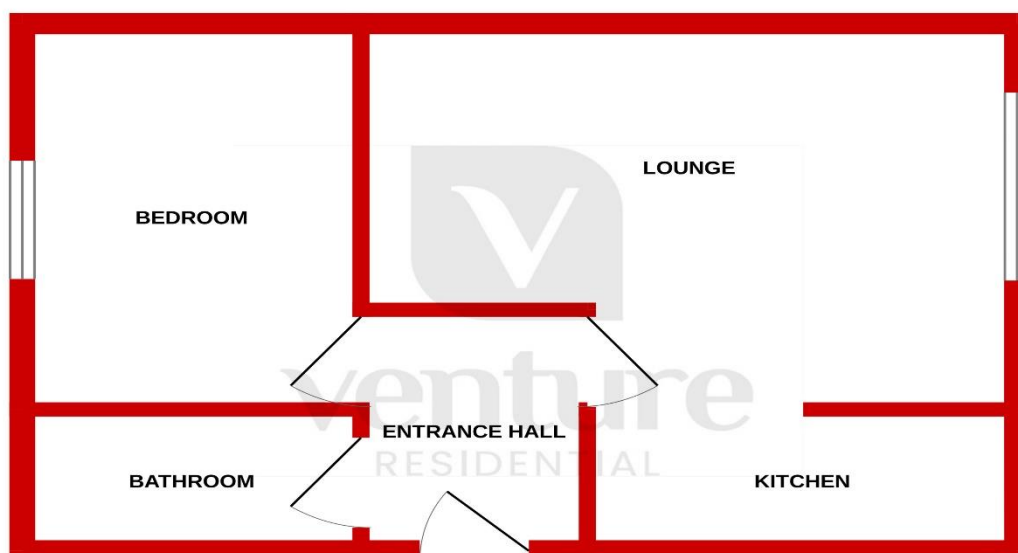

Whilst every attempt has been made to ensure the accuracy of the floorplan contained here, measurements of doors, windows, rooms and any other items are approximate and no responsibility is taken for any error, omission or mis-statement. This plan is for illustrative purposes only and should be used as such by any prospective purchaser. The services, systems and appliances shown have not been tested and no guarantee as to their operability or efficiency can be given.
Made with Metropix ©2025

Notice

Please note we have not tested any apparatus, fixtures, fittings, or services. Interested parties must undertake their own investigation into the working order of these items. All measurements are approximate and photographs provided for guidance only.



**9 Compton Avenue,
Luton,
Bedfordshire,
LU4 9AX**

T: 01582 249155

E: info@venture-residential.co.uk



rightmove.co.uk
The UK's number one property website



OnTheMarket

Zoopla