

Ground floor area approx.... 377 sq.ft (35 sq.m)
Total floor area approx.... 689 sq.ft (64 sq.m)

2D Floor Plan

Floor plans are for illustrative purposes only and should be used as such by a prospective purchaser. Measurements are approximate and no responsibility is taken for any error, omission or mis-statement and should not be relied upon for the purchase of carpets or any other fixtures or fittings.

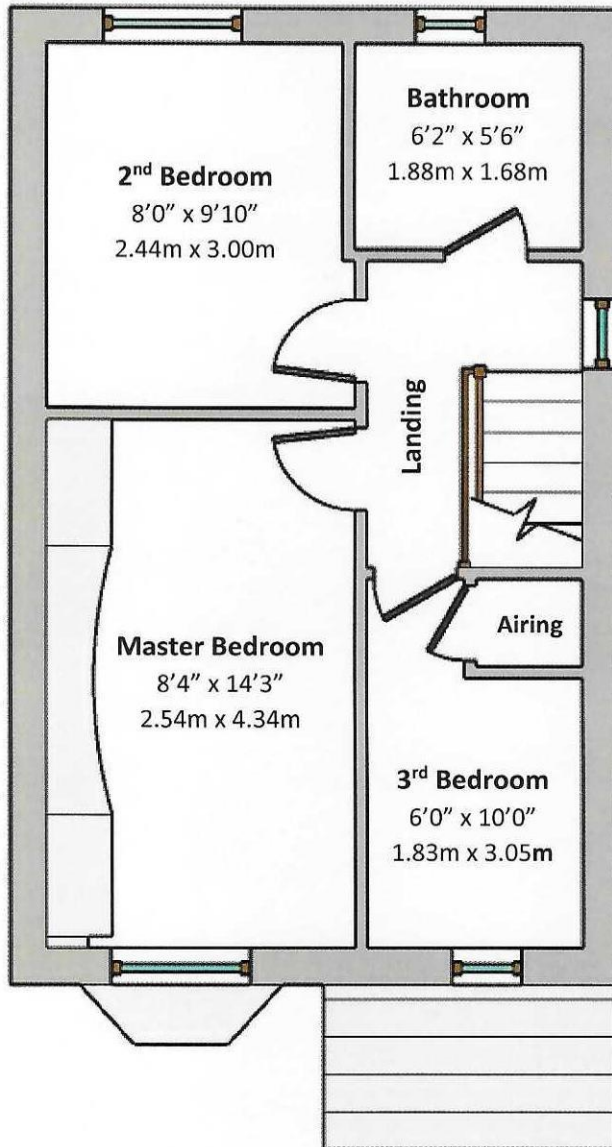

First Floor area approx.... 312 sq.ft (29 sq.m)
Total house floor area approx.... 689 sq.ft (64 sq.m)

2D Floor Plan

Floor plans are for illustrative purposes only and should be used as such by a prospective purchaser. Measurements are approximate and no responsibility is taken for any error, omission or mis-statement and should not be relied upon for the purchase of carpets or any other fixtures or fittings.